



PERMIT APPLICATION

Revocable Occupancy / Street Privilege for Communications

This application for installation and maintenance of communications infrastructure, such as fiber optics, telephone, and cable.

City of La Crosse Engineering Department

Phone: (608) 789-7505

engineering@cityoflacrosse.org

Encroachment Owner

Name: _____ Company: _____

Address: _____ City: _____ State: _____ Zip: _____

Phone: _____ Email: _____

Application Preparer (if different from above)

Name: _____

Relationship with owner: _____

Phone: _____ Email: _____

Proposed Encroachment

Description: _____

Encroachment Address(es) (list by street and 100 blocks and attach a drawing of encroachment):

[Empty box for drawing and address details]

I certify that I have reviewed the Municipal Code and understand all that is related to this permit request. I further certify that I have the full authority to make the foregoing application; the information in the application and the required submittals are complete and correct; the Work or Use performed shall comply with all the laws of the State of Wisconsin, and all ordinances, rules, regulations, policies and special conditions of the City of La Crosse. The applicant agrees to perform the work covered by an approved permit with diligence and convenience to the public.

Signature of owner or designee: [Signature] Date: _____

Print name and title: _____

Below this line to be completed by City staff only

Required items to be provided by Applicant:

- Scale drawing of encroachment on letter-size paper(s)
Certificate of Insurance (City as additional insured)
Application fee \$ 75
City Utility Potential Conflict Notification and Sign-Off

Encroachment type: _____ Permit number: _____

Board of Public Works approval date: _____

All fees are non-refundable.



PERMIT CONDITIONS

Revocable Occupancy / Street Privilege for Communications

City of La Crosse Engineering Department

Phone: (608) 789-7505

engineering@cityoflacrosse.org

See Municipal Code Section 40-61 through 40-72 and 40-106 for complete information.

To apply for a permit:

- Return this completed application along with required information and fees noted on the application via email to engineering@cityoflacrosse.org or mail to or drop off at City of La Crosse, Engineering Department, 400 La Crosse Street, La Crosse, WI 54601.
- You will then be given notice of when your request will be on the Board of Public Works agenda for consideration. Your presence might be required to discuss your application.
- **Average completion time for validation 45 days.**

Follow these regulations:

1. The applicant shall be primarily liable for damages to person or property by reason of the granting of this street privilege permit.
2. The applicant shall obtain an excavation permit from the City of La Crosse Engineering Department prior to performing installation or any maintenance on the cable in the City right-of-way that requires excavation or disruption of surface, pavement, sidewalk, curb and gutter, or other structure.
3. The applicant agrees that tracer wires shall be used and final cable location within the street right-of-way shall be approved by the City Engineer. Cable shall be installed not less than 36 inches deep, unless otherwise approved by the City Engineer.
4. Applicant agrees to provide the City of La Crosse with final "as-built" plans when installation is complete.
5. Applicant agrees that any pavement, concrete or green space disturbed during drilling activities shall be restored to its prior condition.
6. Applicant agrees that said installation shall not interfere with the City's water, sanitary sewer, storm sewer, electric, or fiber underground infrastructure that may be in the area.
7. Applicant further agrees that they will make arrangements with the public utility companies and the City of La Crosse to clear all public underground utilities prior to initiating such work, and if necessary, applicant will make arrangements with the City of La Crosse to ensure proper traffic control.
8. Applicant waives any and all rights to contest in any way or manner the validity of Sec. 66.0425 of the Wisconsin Statutes and the amount of compensation charged.

Failure to obtain a permit before commencement of work will result in a permit fee of \$500.

9. Applicant agrees to become a member of Diggers Hotline for marking / locating of utility.
10. The applicant for a permit to encroach on the public right-of-way shall procure and maintain for the duration of the permit a minimum liability and contractual liability policy in the amount of \$100,000.00 each person, \$300,000.00 each accident for bodily injury and \$100,000.00 for property damage. A certificate of such insurance shall be filed with the City Engineer as part of the application. The insurance shall name the City, its officials, employees and agents as additional insureds. The Board may require greater insurance protection on a case-by-case basis.
11. Applicant further agrees to hold harmless the City for any damage to said cable while the City, its agents or contractors are conducting construction for maintenance activities in or upon such area in which said cable lies; provided, however, the City shall make a good faith effort to notify applicant of any maintenance or work in the area of the street privilege permit which may damage applicant's cable.
12. Applicant agrees to remove the cable and return the area to its original condition upon ten (10) days' notice by the Board of Public Works. The applicant further agrees that if it does not remove the cable within ten (10) days after receiving notice, the City is authorized to remove the same and applicant agrees to pay the City for all costs of such removal.
13. Applicant further agrees that the obligations and conditions of this street privilege permit shall be binding upon all heirs, successors and assigns of applicant.
14. The person(s) signing this Permit warrant that they have the authority to sign as, or on behalf of, the party for whom they are signing.

Failure to obtain a permit before commencement of work will result in a permit fee of \$500.

MUNICIPAL MAP
CITY OF LA CROSSE

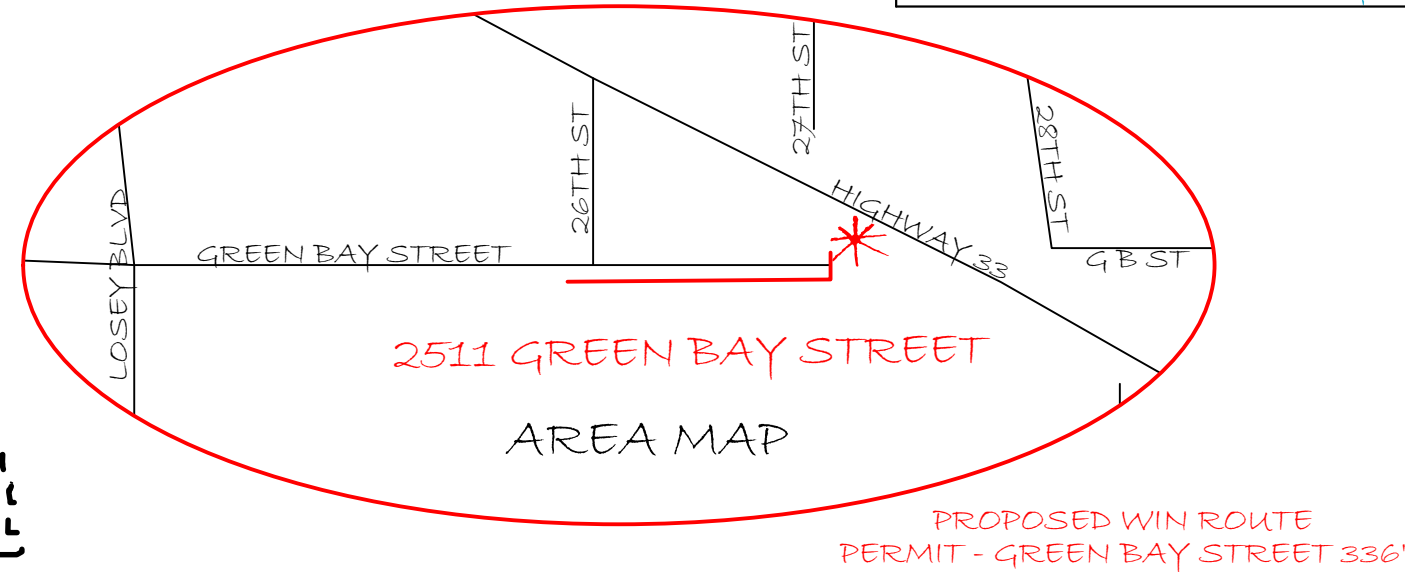
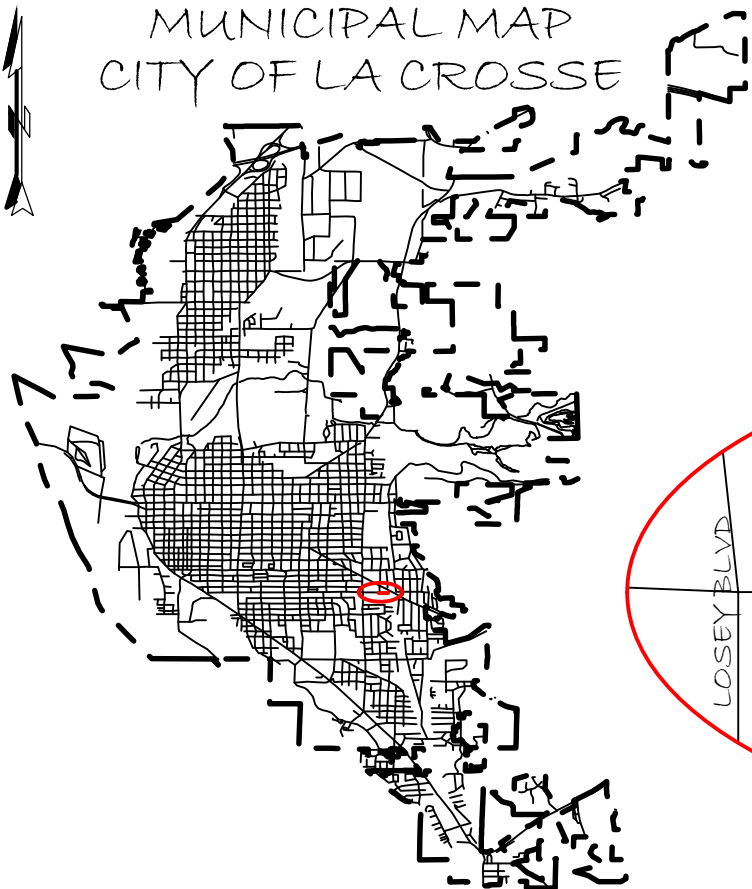

NARRATIVE

Project Overview

This is a line extension project to provide a mobile back-haul carrier transport circuit to 2511 Green Bay Street, La Crosse, WI. Work includes extending facilities from a WIN existing network access point east along Green Bay Street within the public right-of-way corridor.

Scope of Work

Main Line Construction: Install one (1) 1.25" HDPE conduit for fiber optic cable placement within the south right-of-way corridor of Green Bay Street, crossing the right-of-way to the north side at end of road, from a WIN access point to 2511 Green Bay Street. Place one (1) 24ct fiber optic cable through the newly installed conduit. Install new handholes/maintenance structures as required for access, pulling, and splicing.
Lateral Service: Pull fiber through customer owned existing 2.00" HDPE conduit. Perform fiber splicing, testing, and light level verification to establish service to the new development.

Construction Methods

Combination of directional bore and trenching as permitted by site conditions and City of La Crosse right-of-way standards. Construction contractor must adhere to all permit provisions, notes, & requirements as listed on the approved permit(s). Construction contractor is responsible for all pre and post construction notifications. A copy of the permit(s) must be on the project site at all times. Follow all WIN Technology construction notes and typical detail drawings.

City of La Crosse Utility Clearance

Maintain the following minimum clearance, measured from the outside of the proposed utility to the outside wall of the existing facility:
Storm Sewer Mains/Laterals: 3 ft horizontal and 2 ft vertical clearance. (City of La Crosse is planning to update storm sewer utility along the fiber route - please note suggested depths at proposed crossing locations highlighted on the work print).

Traffic Control and Safety

All work conducted within the public right-of-way will adhere to City of La Crosse, Wisconsin Department of Transportation (WisDOT), and Manual on Uniform Traffic Control Devices (MUTCD) standards. A traffic control plan (TCP) will be implemented prior to the start of construction and maintained throughout the project duration. Appropriate signage, cones, barricades, and flagging operations, as required, will be used to safely manage vehicle and pedestrian traffic. Access to driveways, sidewalks, and public walkways will be maintained at all times or temporarily restored as required. Work zones will be clearly marked, and all personnel will wear proper high-visibility safety apparel in accordance with OSHA and MUTCD requirements.

Restoration and Compliance

All construction and restoration activities will comply with applicable City of La Crosse and utility owner standards. Upon completion of work, all disturbed areas will be restored to equal or better than pre-construction condition. Restoration activities include:

- * Proper backfill and compaction of all excavations and bore pits
- * Replacement of asphalt, concrete, turf, and landscaping as applicable
- * Erosion and sediment control per municipal and state standards
- * Final inspection and approval by municipal representatives prior to project closeout

Project 600: Green Bay Street

During project design, I discovered a planned reconstruction of Green Bay Street and requested project 600 roadway plans and available utility information to avoid conflict with our proposed fiber optic design. The City of La Crosse provided an update on the project status (construction planned for 2029), noting that civil plans and storm sewer design were not yet developed. Review comments were provided on our preliminary fiber layout drawing, and it was confirmed that WIN will be included in future coordination as storm sewer and utility design progresses.

PERMITS					EASEMENTS				
PERMITTING AUTHORITY	RIGHT-OF-WAY	SHT RGE	APPROVAL	PERMIT NO.	OWNER	PROPERTY ADDRESS	PARCEL #	SHT RGE	APPROVAL
CITY OF LA CROSSE	GREEN BAY STREET	D1			NONE				

PUBLIC LAND SURVEY SYSTEM								
SHEET	COUNTY	MUNICIPALITY	POLITICAL TOWNSHIP	TWN	RGE	SEC	QUARTER/QUARTER	ROAD NAME
D1	LA CROSSE	CITY OF LA CROSSE	LA CROSSE	15N	7E	9	NW¼ OF THE NE¼	GREEN BAY STREET

PROJECT INFORMATION			WIN PROJECT CONTACTS			
CONVERSION/PROJECT #	647/08-171		EMERGENCY	NMC	866-206-2027	support@wintechology.com
PROJECT NAME	OSP EXTENSION-2511 GREEN BAY ST-LA CROSSE-T-MOBILE		OSP ENGINEER	KEN WHITING	920-376-2996	ken.whiting@wintechology.com
SERVICE LINE	001 - CARRIER TRANSPORT		CONST COORD	JOHN LOUIS	715-838-4012	john.louis@wintechology.com
SERVICE TYPE	MOBILE BACKHAUL		ISP ENGINEER	J. PEREZ-SANCHEZ	715-858-3060	javier.perez-sanchez@wintechology.com
CIRCUIT ID/DFS NO.	606769		PROVISIONER	SHEILAH BERG	715-832-6156	sheilah.berg@wintechology.com
COST ESTIMATE	SL-24042		SALES	DUSTIN DUNAWAY	715-450-5406	dustin.dunaway@wintechology.com

TIMELINES			
AS-STAKED (AS)	FINAL PLANNED DESIGN - EXACT INTENDED LOCATION(S) OF PROPOSED UTILITY	17 MAR 2026	KW
ISSUED FOR REVIEW (IFR)	PLANS RELEASED FOR STAKEHOLDER EVALUATION AND COMMENTS - NOT FOR CONSTRUCTION	17 MAR 2026	KW
REVISION 1 (REV)			
APPROVED (AP)	PLANS REVIEWED AND ACCEPTED BY CONSTRUCTION COORDINATOR	19 MAR 2026	JL
ISSUED FOR CONST (IFC)	PLANS ARE FULLY APPROVED, FINAL, AND AUTHORIZED FOR CONSTRUCTION		
REDLINES (RL)	PLANS ARE MARKED-UP SHOWING COMMENTS AND FIELD CHANGES		
AS-BUILT (AB)	FINAL RECORD DRAWINGS REFLECTING ACTUAL CONSTRUCTION		

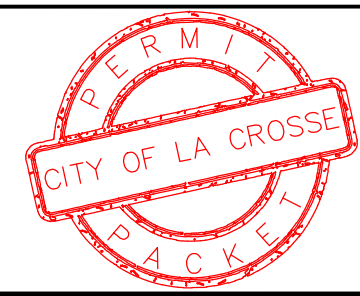

MEMBER
WISCONSIN STATUTE 182.0175 (1974) REQUIRES CONTRACTORS TO NOTIFY DIGGERS HOTLINE A MINIMUM OF THREE BUSINESS DAYS PRIOR TO EXCAVATION AT 811 OR (800) 242-8511 OR (262) 432-7910. EMAIL-A-LOCATE IS AVAILABLE AT: WWW.DIGGERSHOTLINE.COM
ONE-CALL

NOTICE
Information contained in this document is proprietary and shall not be used, copied, reproduced, or disclosed, in whole or in part, without written consent of WIN, LLC.
SHEET C-1 OF C-4
P&S SHEET 1 OF 6

GENERAL CONSTRUCTION NOTES

- 1) State Law requires excavators to notify the One-Call System prior to all excavations. Hand dig with care within the 18" safety zone when exposing underground utilities. Caution - One Call may not mark all private lines.
- 2) Underground utilities have been plotted from available records and field observations but are not necessarily exact. It is the contractor's responsibility to field locate all underground obstructions and utilities prior to construction. Complete repair of any and all damages incurred shall be at the expense of the construction contractor. Fiber placement subject to change upon field locate completion.
- 3) Coordinate all construction activities with the WIN Technology OSP Construction Coordinator prior to construction.
- 4) Contractor is responsible for any erosion control, which includes submitting erosion plans, related to this project, should it become necessary.
- 5) Construction contractor shall provide all information for as-built drawings, including but not limited to: Fiber sequential's at hand hole walls and end of fiber; Depths of fiber at a minimum of 200' intervals along with centerline of all hard surface crossings, ie: roads, alleys, drives, waterways pipelines, railroads; Actual GPS location of hand holes; Actual running line from right-of-way, back of curb, edge of pavement or other known landmarks shown on sheets; Actual location of warning markers; and any other information required to produce an accurate and permanent record of the project.
- 6) The top of all hand holes set shall match final grade.
- 7) The contractor shall comply with all WIN Technology policies and procedures and all requirements from local permitting authorities. The various permits obtained for the project are on file in the office of the WIN Technology OSP Project Engineer.
- 8) Miscellaneous structures and obstructions such as sign posts; mail boxes; meter boxes; or other obstructions shall be avoided or removed and reinstalled to original or better condition.
- 9) The contractor shall be responsible, at all times; for the maintenance of streets and other utilities affected by construction operations - debris shall not be permitted to accumulate and all premises shall be maintained in a neat and workmanlike condition.
- 10) The contractor shall take adequate precautions to protect existing facilities, sidewalks, curbs, pavements, utilities, foliage, and adjoining property and structures outside of right-of-way; and to avoid damage thereto.
- 11) The following special provisions shall apply to traffic and pedestrian regulations during the extent of this project:
 - a. There shall be, at all times, adequate vehicle and pedestrian access for ingress and egress for the properties adjacent to the project.
 - b. During non-working hours, the contractor shall keep the existing traffic lanes clear from interference including all approaches and intersections.
 - c. If lane blockage is unavoidable, the contractor shall notify the traffic engineering department, police department, fire department, ambulance services, school bus garages, and other agency operations as appropriate so these agencies may re-route their vehicles around the construction zone(s).
 - d. Contractor is responsible to adhere to the State DOT manual on traffic control along with submitting traffic plans if required by permitting authority.
- 12) If required, trenches in paved areas shall be saw-cut to the full depth of surfacing or as required by the permitting authority. Paved surfaces shall be repaired in accordance with the permitting authority's specifications.
- 13) The contractor shall comply with all current and applicable Occupational Safety and Health Administration (OSHA), federal, state, and local rules and regulations governing the safety of employees and material during excavation, trenching, ditching, and installation and backfilling operations on this project.
- 14) No trench or excavation site shall be left open overnight or unattended.
- 15) Right-of-way restoration and street and sidewalk repair/replacement shall be in compliance with the local permitting authority.
- 16) All fiber cable minimum depth must be 36". 48" minimum depth under roadways and waterways. See typical roadway and waterway crossing details.
- 17) Inner ducts occupied by cable shall be sealed at termination points using rubber plugs and compression bands. Foam sealant will not be used.
- 18) Brushing and trimming as-required. Brush, branches, and refuse from clearing operations shall, without delay, be removed from the vicinity of the right-of-way.
- 19) Construction contractor(s) shall have a copy of the permit(s) on-site and shall be available for inspection immediately upon request by the permitting authority or permitting authority representative.
- 20) No excavation, digging, tunneling, trenching, boring, plowing, installation of facilities, equipment or improvements above, on or beneath the surface of any right-of-way may begin without a signed permit from the governing permitting authority.

TYPICAL DETAIL DRAWINGS

TYPICAL ROADWAY CROSSING

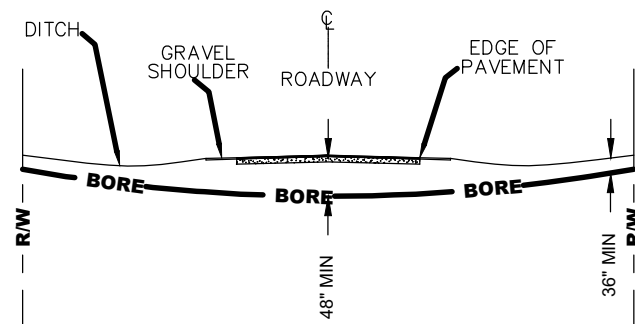

ALL DIMENSIONS SHOWN ARE MINIMUM DEPTHS
 PROPOSED FACILITIES PLACEMENT SHALL CROSS ALL EXISTING STREETS AT 48" MINIMUM DEPTH
 PERMITTING AUTHORITIES MAY REQUIRE GREATER THAN 48" MINIMUM DEPTH ROAD CROSSINGS

TYPICAL WATERWAY CROSSING

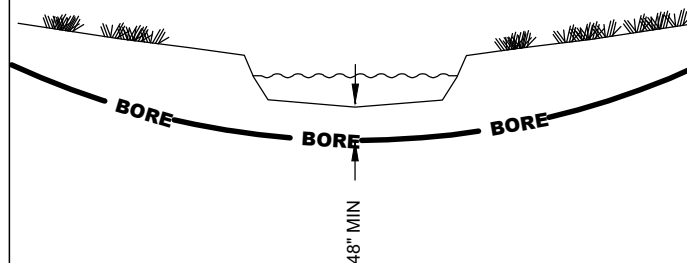

ALL DIMENSIONS SHOWN ARE MINIMUM DEPTHS
 PROPOSED FACILITIES PLACEMENT SHALL CROSS ALL WATERWAYS AT 48" MINIMUM DEPTH FROM BASE OF WATERWAY
 PERMITTING AUTHORITIES MAY REQUIRE GREATER THAN 48" MINIMUM DEPTH

TYPICAL UTILITY CROSSING

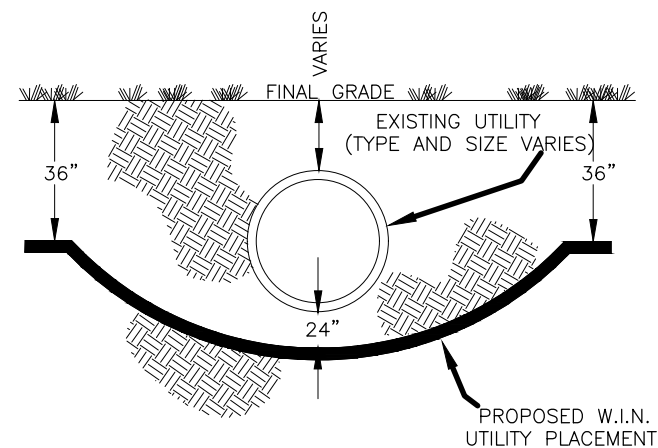

ALL DIMENSIONS SHOWN ARE MINIMUM DISTANCES
 PROPOSED FACILITIES PLACEMENT SHALL CROSS ALL EXISTING UTILITIES WITH A 24" MINIMUM VERTICAL AND HORIZONTAL SEPARATION
 FOREIGN UTILITY OWNERS AND/OR PERMITTING AUTHORITIES MAY REQUIRE GREATER THAN 24" SEPARATIONS

TYPICAL BORE DETAIL

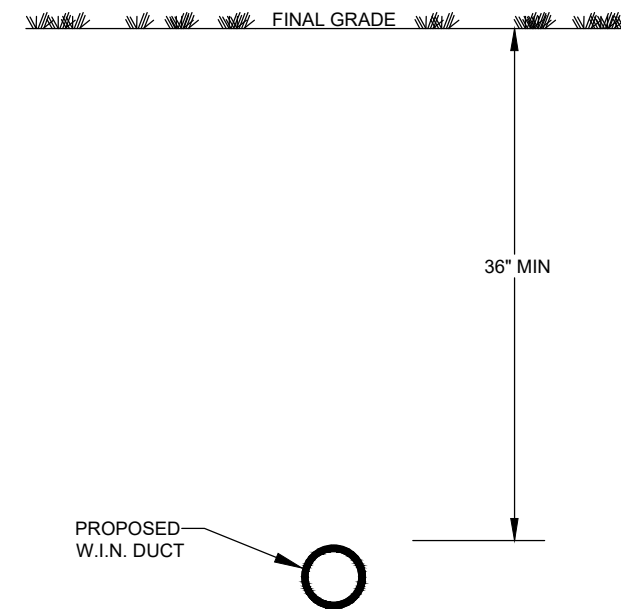

MAINTAIN MINIMUM HORIZONTAL AND VERTICAL SEPARATION OF EXISTING UTILITIES; REVIEW PERMITTING AUTHORITIES SPECIFICATIONS AND DETAILS FOR SEPARATION REQUIREMENTS
 NOT TO SCALE

TYPICAL TRENCH DETAIL

BMT1 (ONE DUCT - 2" OR LESS)
 1 DUCT HORIZONTALLY BY 1 DUCT VERTICALLY

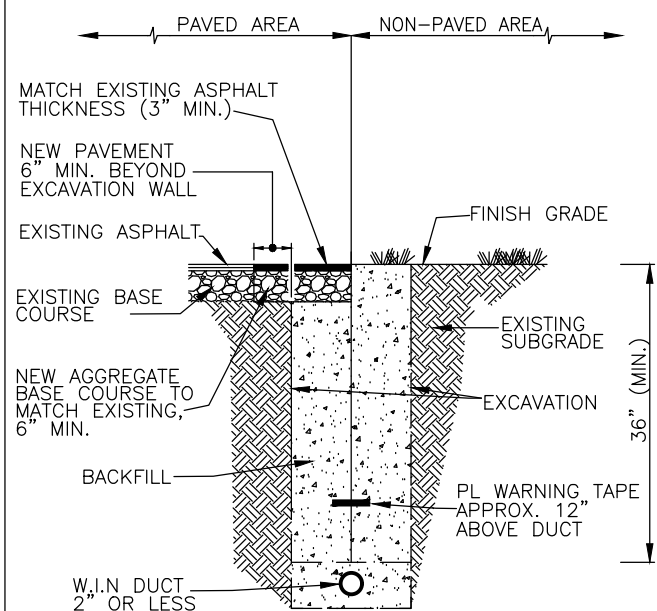

MAINTAIN MINIMUM HORIZONTAL AND VERTICAL SEPARATION OF EXISTING UTILITIES; REVIEW PERMITTING AUTHORITIES SPECIFICATIONS AND DETAILS FOR SEPARATION REQUIREMENTS
 NOT TO SCALE

TYPICAL WARNING SIGN MARKER POST

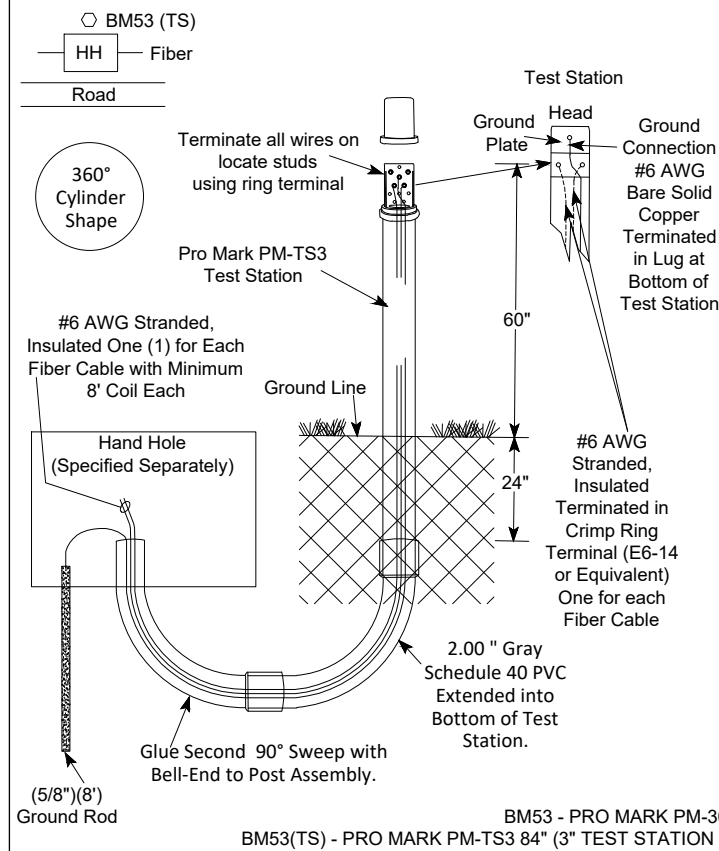

-- NOTES --

- Cap Colors:
 -- Black: Warning Post Only
 -- White: Hand Hole with Slack
 -- Green: Test Station at Splice Locations
- Test Station to be Installed in Center of Long Side of Hand Hole Away from Roadway
- Test Station Assembly Unit includes: 84" Dome Pro Mark Marker Post with 5 Position Test Station; 5/8" x 8' Ground Rod; Ground Rod Clamp; 2 - 2.00" 90° Duct Sweeps; Isolation Lever.
- Test Station Conductors:
 -- Ground Rod to Locate Plate: #6 Bare Solid
 -- Test Station to Hand Hole for Each Cable: #6 Stranded, Insulated
 -- #6 Bare Solid Terminated in Lug at Top of Test Station for Ground
 -- Stranded #6 to be Terminated in Crimp Ring Terminal T&B E-6-14 or Equivalent
- BM53 Markers will require Post Anchor. Set BM53 Markers 18" Below Ground Line.



BM53 - PRO MARK PM-303 DOME MARKER 72"
 BM53(TS) - PRO MARK PM-TS3 84" (3" TEST STATION WITH STANDARD 5 STAINLESS STEEL TERMINALS)

TYPICAL HANDHOLE DETAIL VIEW FROM TOP

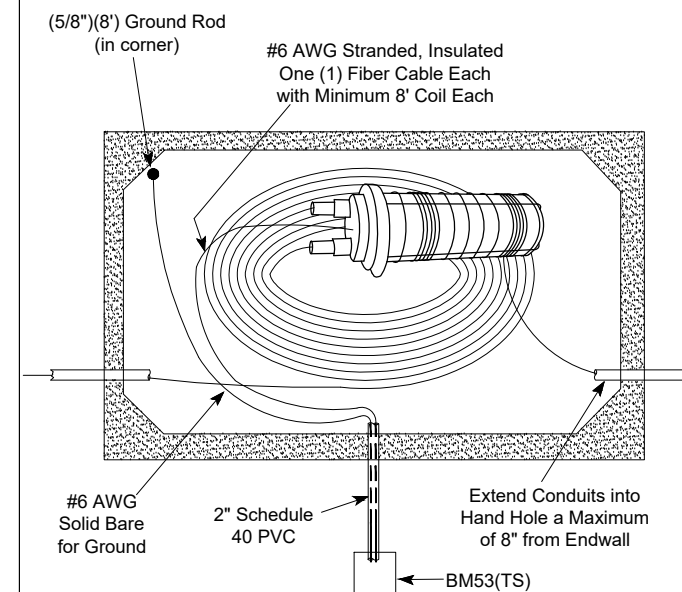

6" COMPACTED #1 Washed Stone (not shown)
 1/4" SCREEN MESH (not shown)
 NOT TO SCALE

TWN: 15N
 RGE: 7W
 SEC: 9
 SCALE: 1.00"=40'

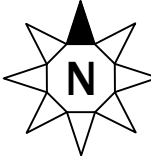

PROJECT NO.: 647/08-171
 PROJECT OVERVIEW:
 OSP DESIGN - LINE EXTENSION -
 CREATE CIRCUIT PATH TO 2511
 GREEN BAY STREET WITHIN SOUTH
 RIGHT-OF-WAY CORRIDOR OF
 GREEN BAY STREET FROM
 EXISTING WIN CONNECTION AT
 STA. 0+43 GB W - LA CROSSE -
 WI - 606769

STATE: WISCONSIN
 CNTY: LA CROSSE
 MUNI: CITY OF LA CROSSE
 TOWNSHIP: LA CROSSE
 R.O.W.: GREEN BAY STREET
 WIN PROJECT ENGINEER
 KEN WHITING
 920-376-2996
 ken.whiting@wintechnology.com
 WIN CONSTRUCTION COORDINATOR
 JOHN LOUIS
 715-864-2918
 john.louis@wintechnology.com

PERMITS:
 1. CITY OF LA CROSSE

UNIT	ACTL	UNIT DESCRIPTION
		BM75
336		BMDB1
2		BMT1
1		UH36
		UH48-2
		WDMP2
		BM74
1		BM53(TS)
1		BM22
2		WUH
		UFOP(48)
		UFOP(48) COIL
336		UFOP(24)
175		UFOP(24) COIL
425		UFOP(6)
75		UFOP(6) COIL

SHEET D-1 OF D-2
 P&S SHEET 5 OF 6

CUSTOMER TO PLACE 1 - 2.00" DUCT FROM MEET-ME HAND HOLE TO SHELTER ENTRANCE AND PLACE AN LB BOX AND PROVIDE EXTERIOR WALL CORE BORE WITH INTERNAL PATH TO WIN MPOP LOCATION

**C.U.P. (MEET-ME HH)
 STA. 2+59 GB E
 WUH = 1
 BMT1 = 2'
 UFOP(6) = 342'**

**C.U.P.
 STA. 2+59 GB E
 BMDB1 = 336'
 UH36 = 1
 BM53(TS) = 1
 UFOP(24) = 342'
 UFOP(24) COIL = 75'
 UFOP(6) COIL = 75'**

**100' EXISTING DUCT
 1 - 6ct FIBER**

**FUTURE CITY PROJECT
 REPLACE INLET ~48"**

**34' DIRECTIONAL BORE
 1 - 1.25" DUCT / 1 - 24ct FIBER**

**SEE SHEET D-2
 FOR LATERAL
 AND
 TERMINATION
 DETAILS**

**STA. 2+59 GB E
 PL WIN UH36 HH
 75' COIL**

**PL WIN UH36 HAND HOLE 2+59 GB E
 LATITUDE: _____
 LONGITUDE: _____
 24ct SEQ # IN: _____
 24ct SEQ # COIL: _____
 COIL & STORE 75'
 6ct SEQ # COIL: _____
 6ct SEQ # OUT: _____
 COIL & STORE 75'**

**FUTURE CITY PROJECT
 STRM TIE-IN ~36"-48"**

**FUTURE CITY PROJECT
 INSTALL PIPE ~84"**

**302' DIRECTIONAL BORE
 1 - 1.25" DUCT / 1 - 24ct FIBER**

**FUTURE CITY PROJECT
 INSTALL PIPE ~36"-48"**

**C.U.P.
 STA. 0+43 GB W
 WUH = 1
 UFOP(24) COIL = 100'**

**EX WIN UH36 HAND HOLE 0+43 GB W
 LATITUDE: _____
 LONGITUDE: _____
 24ct SEQ # COIL: _____
 24ct SEQ # OUT: _____
 COIL & STORE 100'**

**STA. 0+43 GB W
 EX WIN UH36 HH
 EXISTING 100' COIL**

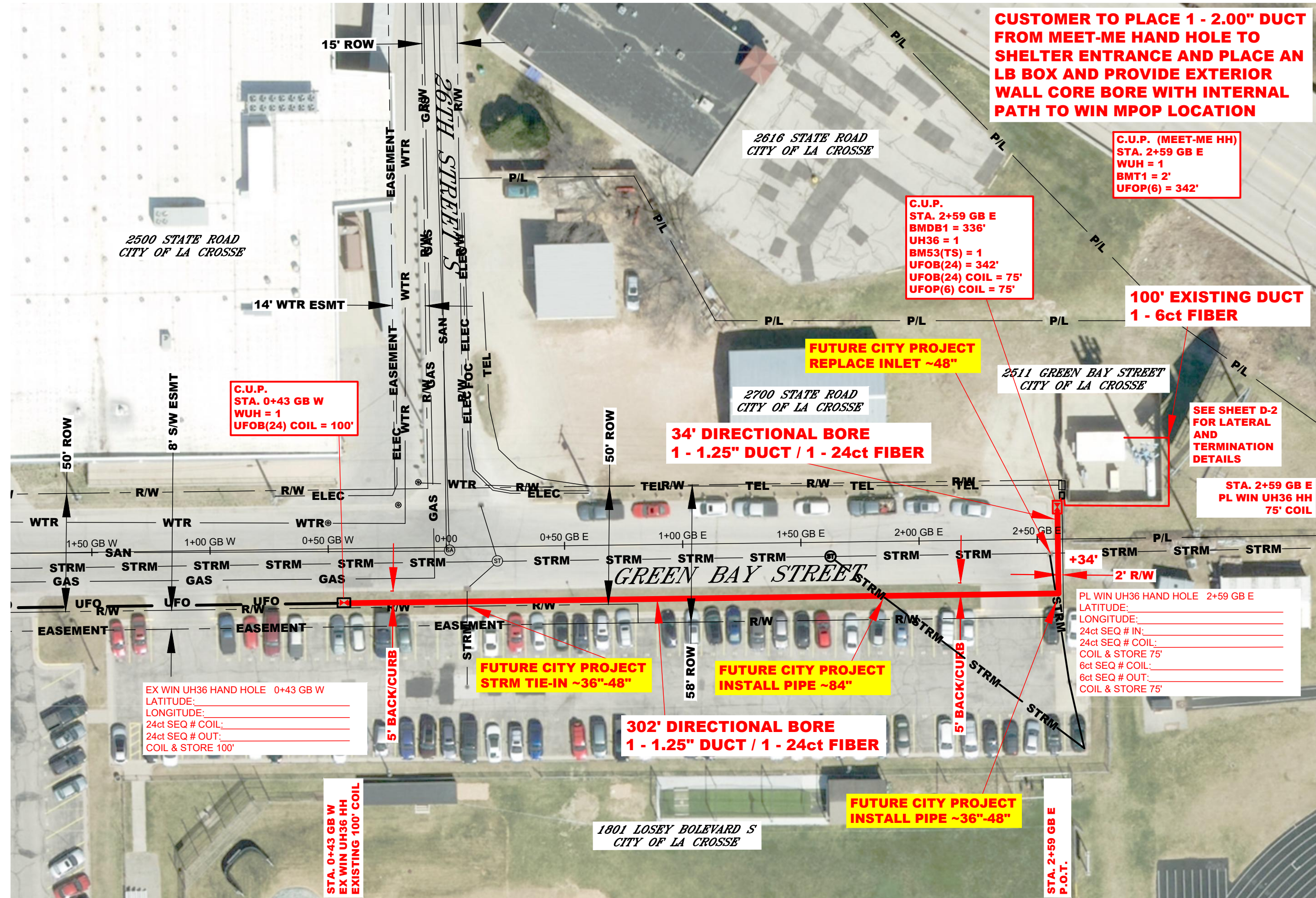

MATCH LINE EXISTING RECORDS