

UNITED STATES Refuse Collection

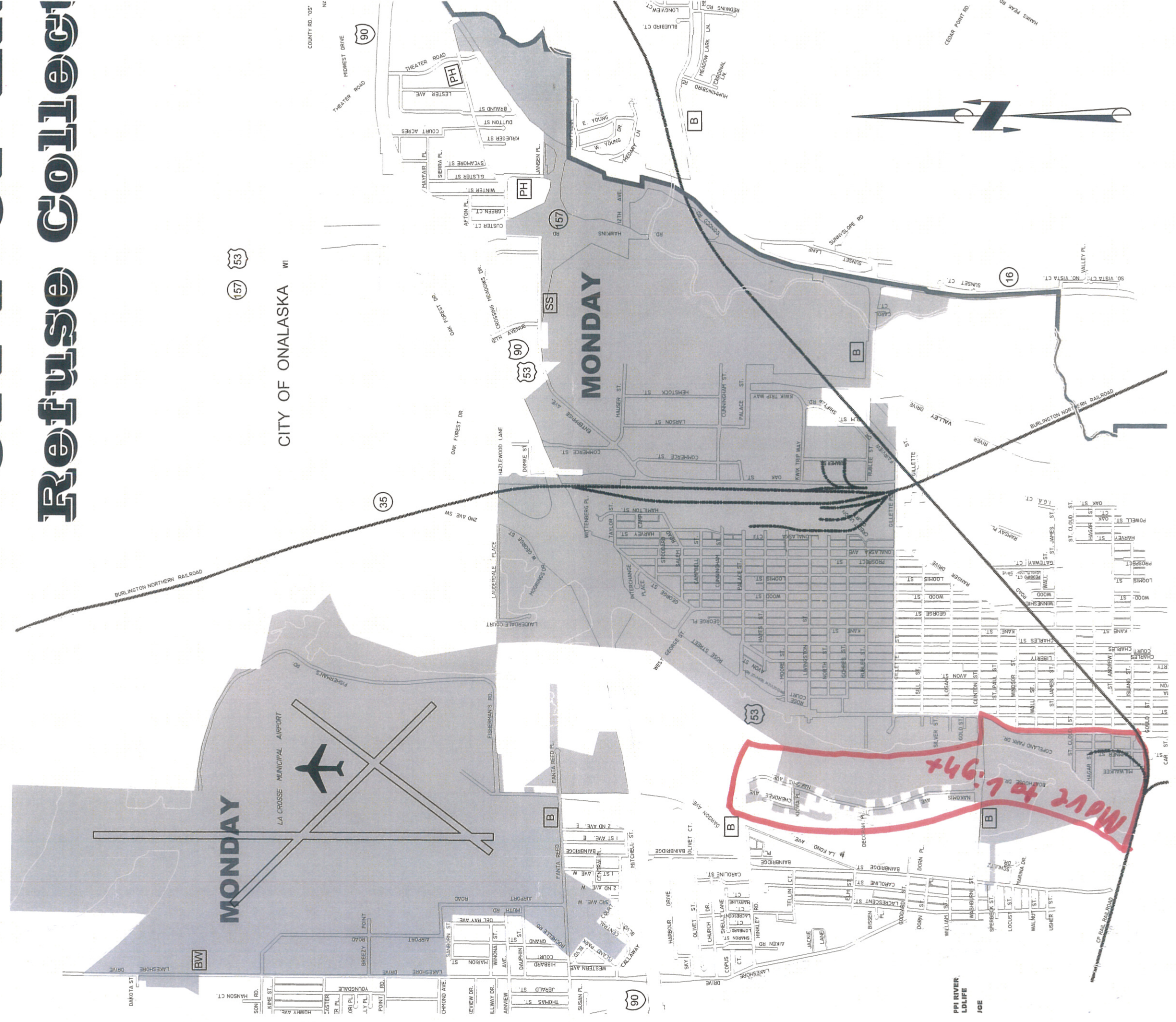

CITY OF ONALASKA WI

CITY OF ONALASKA WI

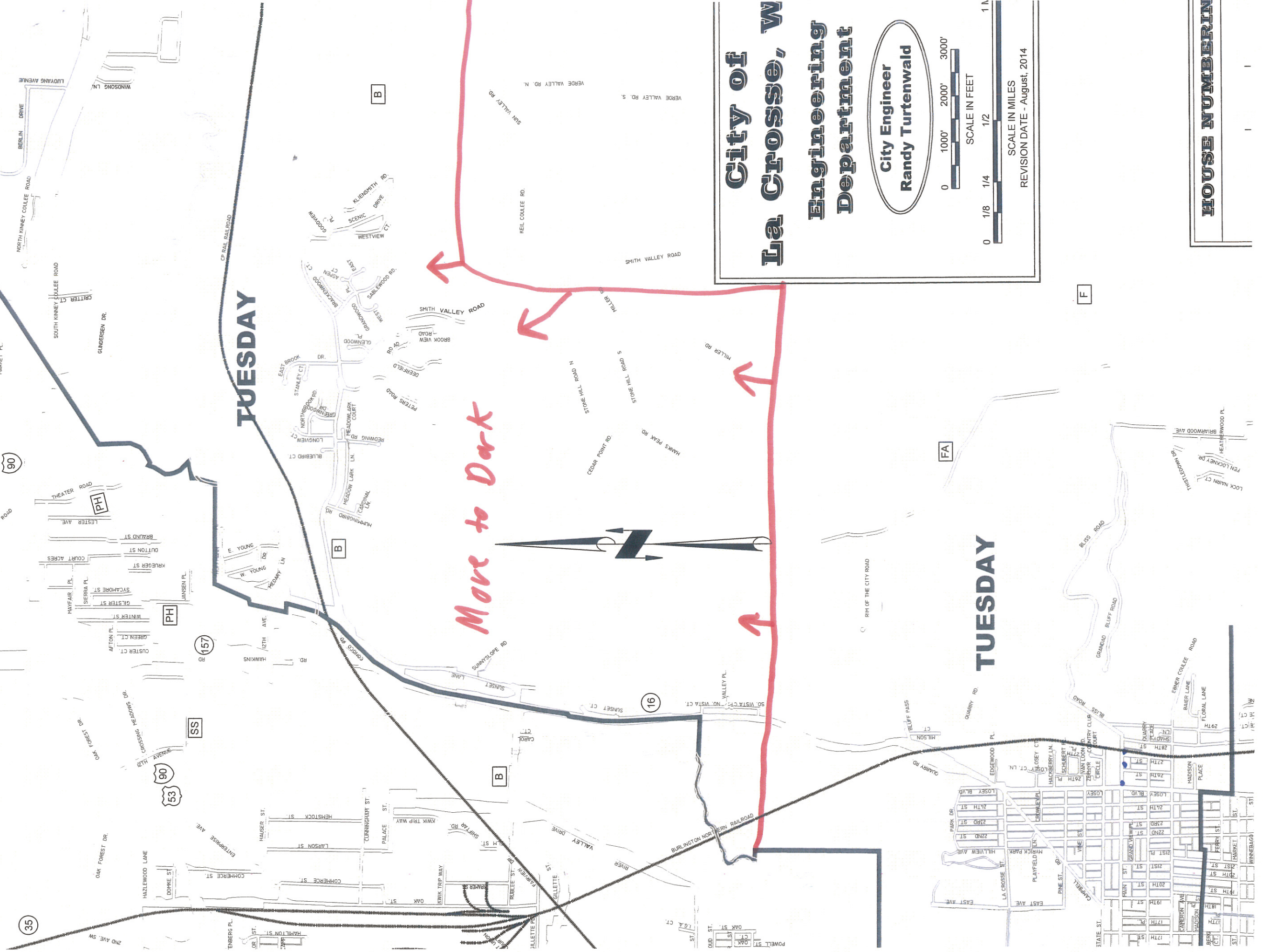

TUESDAY

TUESDAY

More to Dark



**City of
La Crosse, W
Engineering
Department**

**City Engineer
Randy Turtenwald**

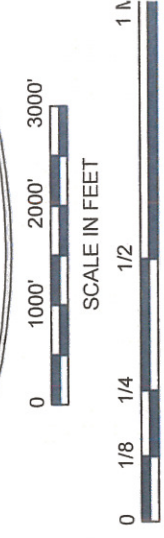

SCALE IN MILES
REVISION DATE - August, 2014

HOUSE NUMBERIN

THURSDAY

Map to Light

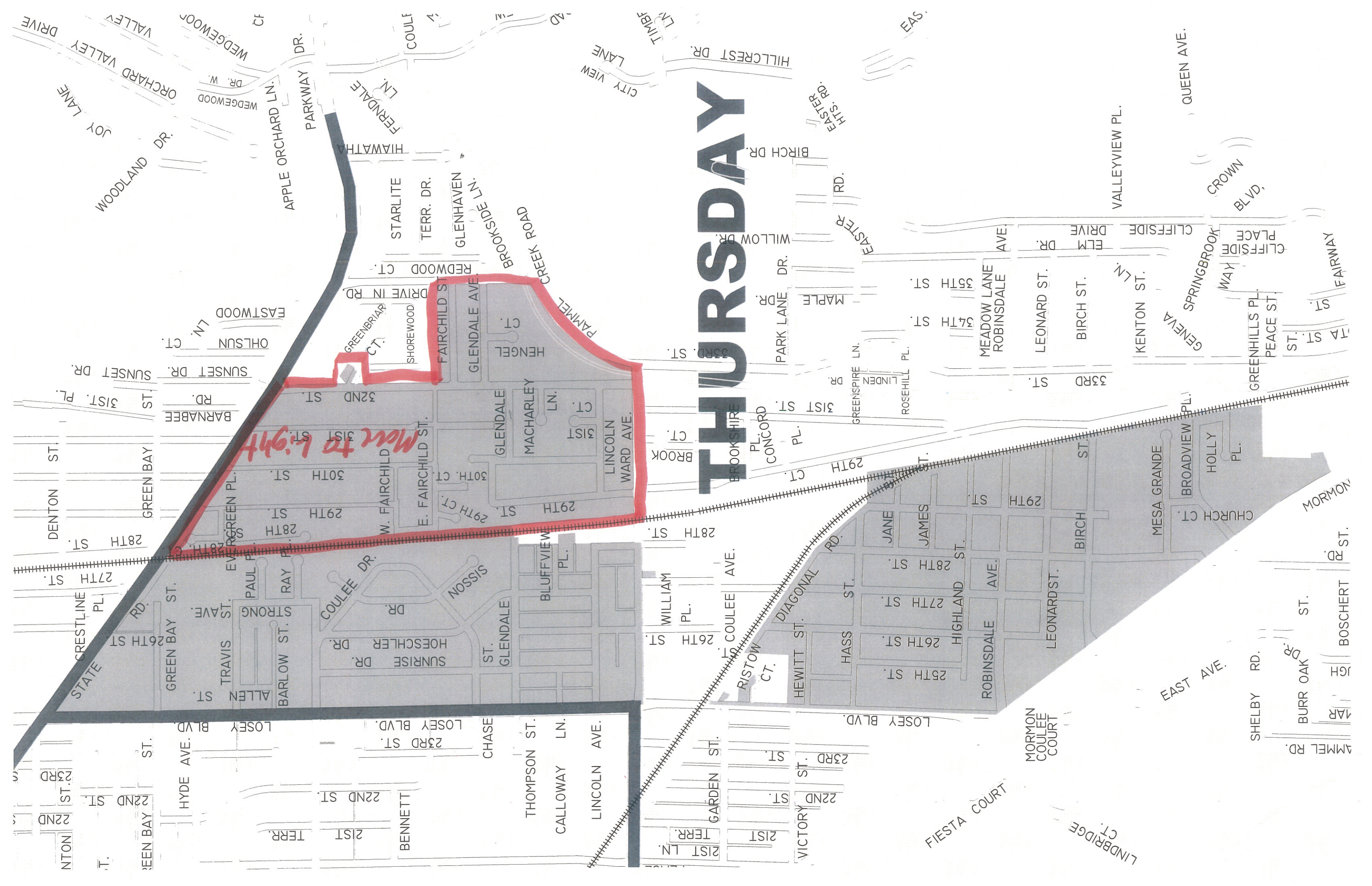

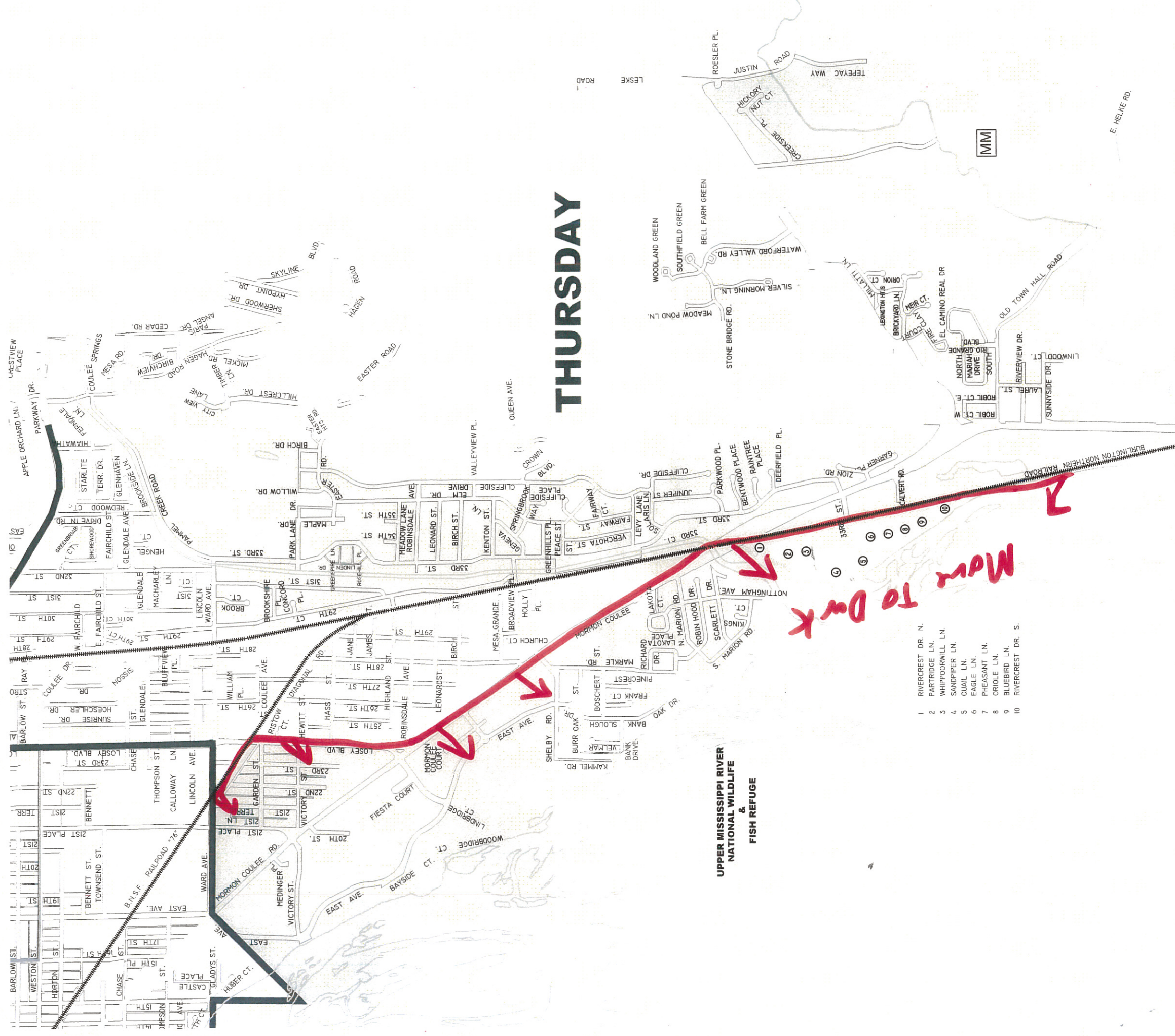

THURSDAY

**UPPER MISSISSIPPI RIVER
&
NATIONAL WILDLIFE
FISH REFUGE**

MORNING TO DARK

- 1 RIVERCREST DR. N.
- 2 PARTRIDGE LN.
- 3 WHIPPOORWILL LN.
- 4 SANDPIPER LN.
- 5 QUAIL LN.
- 6 EAGLE LN.
- 7 PHEASANT LN.
- 8 ORIOLE LN.
- 9 BLUEBIRD LN.
- 10 RIVERCREST DR. S.

WEDNESDAY

Move to Thursdays

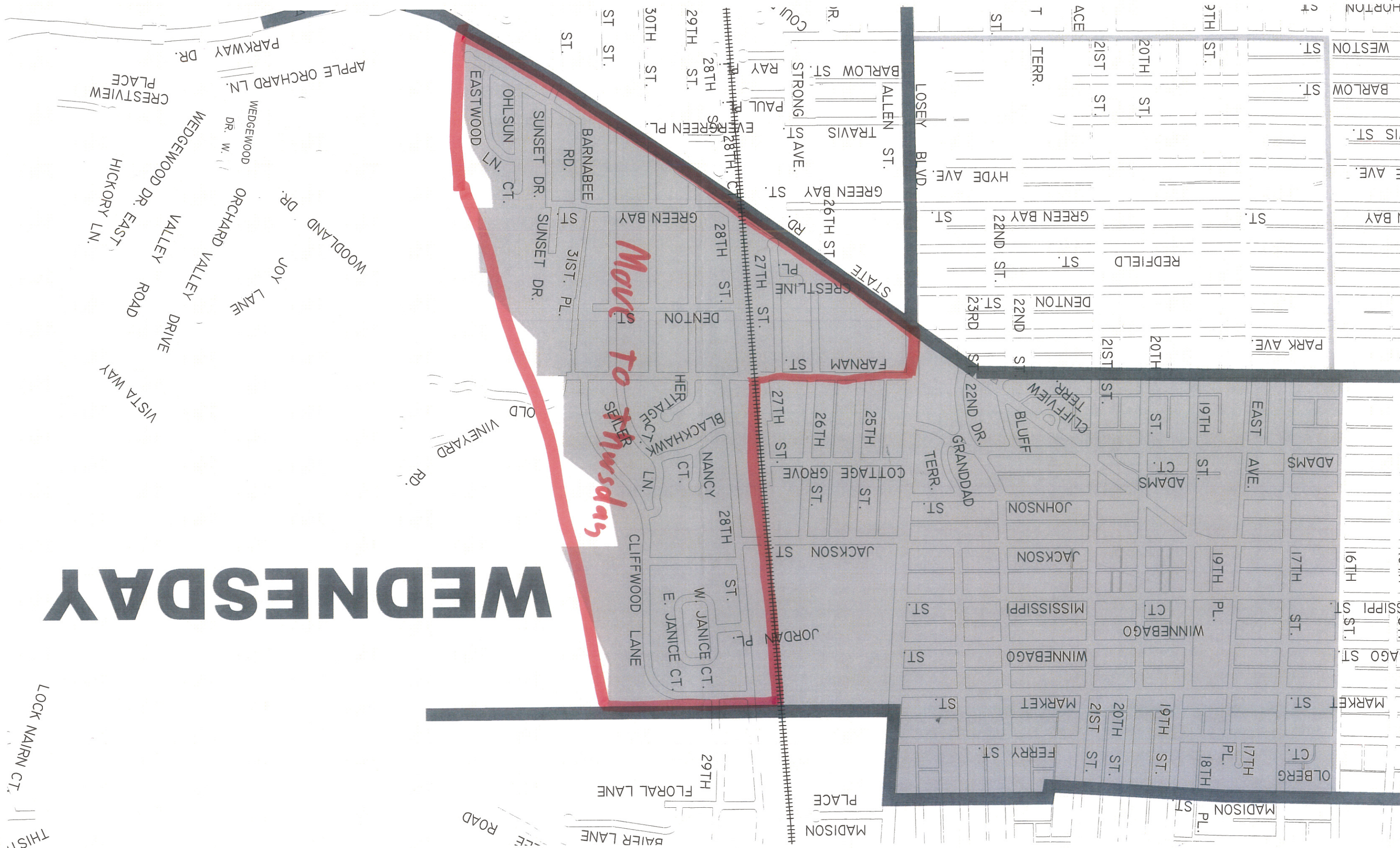

THIS IS LOCK NAIRN CT.

WEDNESDAY

SO. PETTIBONE DR

JOSEPH HOUSKA DR.

MARCO DRIVE

KERTZMAN PL.

NELSON PL.

SOUTH CLINIC CT.

ST. JANSKY PL.

N. PARK ST.

PARK AVE.

S. PARK ST.

REDFIELD ST.

DENTON ST.

TYLER ST.

HONOR LEX DR.

HOOD ST.

4TH ST.
5TH AVE.

7TH ST.

8TH ST.

9TH ST.

HOOD ST.
FARNAM

10TH ST.

ST. 11TH

ST. 11TH

HINTGEN CT.

GRANT CT.

WEST AVE.

13TH ST.

14TH ST.

15TH ST.

MISSISSIPPI ST.

16TH ST.

17TH ST.

FRANCISCAN WAY
MISSISSIPPI ST.
VITERBO DR.
JACKSON ST.

6TH ST.

WINNEBAGO ST.

MARKET ST.

FERRY ST.

WEST AVE.

FERRY ST.

ST.

OLBERG CT.

FRONT ST.

2ND ST.

CROSS ST.

CAMERON AVE.

AVENUE

DIVISION ST.

CAMERON

AVE.

CASS ST.

EAST AVE

ADAMS

FARNAM CT.

ST

GREEN RAY

PARK AVE

MA

CA