

Data file name: U:\Makepeace Engineering\2 Clients\Uploaded\Wieser\Performance Elite Gymnastics\SLAMM\PEG EX SLAMM 20230509.mdb
WinSLAMM Version 10.4.1
Rain file name: C:\WinSLAMM Files\Rain Files\WisReg - Madison WI 1981.RAN
Particulate Solids Concentration file name: C:\WinSLAMM Files\v10.1 WI_AVG01.pscx
Runoff Coefficient file name: C:\WinSLAMM Files\WI_SL06 Dec06.rsvx
Pollutant Relative Concentration file name: C:\WinSLAMM Files\WI_GEO03.ppdx
Residential Street Delivery file name: C:\WinSLAMM Files\WI_Res and Other Urban Dec06.std
Institutional Street Delivery file name: C:\WinSLAMM Files\WI_Com Inst Indust Dec06.std
Commercial Street Delivery file name: C:\WinSLAMM Files\WI_Com Inst Indust Dec06.std
Industrial Street Delivery file name: C:\WinSLAMM Files\WI_Com Inst Indust Dec06.std
Other Urban Street Delivery file name: C:\WinSLAMM Files\WI_Res and Other Urban Dec06.std
Freeway Street Delivery file name: C:\WinSLAMM Files\Freeway Dec06.std
Apply Street Delivery Files to Adjust the After Event Load Street Dirt Mass Balance: False
Source Area PSD and Peak to Average Flow Ratio File: C:\WinSLAMM Files\NURP Source Area PSD Files.csv
Cost Data file name:
Seed for random number generator: -42
Study period starting date: 01/01/81 Study period ending date: 12/31/81
Model Run Start Date: 01/01/81 Model Run End Date: 12/31/81
Date of run: 05-22-2023 Time of run: 13:23:51
Total Area Modeled (acres): 0.682
Years in Model Run: 1.00

	Runoff Volume (cu ft)	Percent Runoff Volume Reduction	Particulate Solids Conc. (mg/L)	Particulate Solids Yield (lbs)	Percent Particulate Solids Reduction
Total of all Land Uses without Controls:	29379	-	125.4	229.9	-
Outfall Total with Controls:	29378	0.00%	125.4	229.9	0.00%
Annualized Total After Outfall Controls:	29459			230.6	

Data file name: U:\Makepeace Engineering\2 Clients\Uploaded\Wieser\Performance Elite Gymnastics\SLAMM\PEG EX SLAMM 20230509.mdb

WinSLAMM Version 10.4.1

Rain file name: C:\WinSLAMM Files\Rain Files\WisReg - Madison WI 1981.RAN

Particulate Solids Concentration file name: C:\WinSLAMM Files\v10.1 WI_AVG01.pscx

Runoff Coefficient file name: C:\WinSLAMM Files\WI_SL06 Dec06.rsvx

Residential Street Delivery file name: C:\WinSLAMM Files\WI_Res and Other Urban Dec06.std

Institutional Street Delivery file name: C:\WinSLAMM Files\WI_Com Inst Indust Dec06.std

Commercial Street Delivery file name: C:\WinSLAMM Files\WI_Com Inst Indust Dec06.std

Industrial Street Delivery file name: C:\WinSLAMM Files\WI_Com Inst Indust Dec06.std

Other Urban Street Delivery file name: C:\WinSLAMM Files\WI_Res and Other Urban Dec06.std

Freeway Street Delivery file name: C:\WinSLAMM Files\Freeway Dec06.std

Apply Street Delivery Files to Adjust the After Event Load Street Dirt Mass Balance: False

Pollutant Relative Concentration file name: C:\WinSLAMM Files\WI_GEO03.ppdx

Source Area PSD and Peak to Average Flow Ratio File: C:\WinSLAMM Files\NURP Source Area PSD Files.csv

Cost Data file name:

Seed for random number generator: -42

Study period starting date: 01/01/81

Study period ending date: 12/31/81

Date: 05-22-2023

Time: 13:24:53

Site information:

LU# 1 - Commercial: C1 Total area (ac): 0.269

1 - Roofs 1: 0.007 ac. Pitched Connected PSD File: C:\WinSLAMM Files\NURP.cpz

31 - Sidewalks 1: 0.015 ac. Connected PSD File: C:\WinSLAMM Files\NURP.cpz

71 - Other Pervious Areas 1: 0.247 ac. Normal Sandy PSD File: C:\WinSLAMM Files\NURP.cpz

LU# 2 - Commercial: C2 Total area (ac): 0.413

13 - Paved Parking 1: 0.314 ac. Connected PSD File: C:\WinSLAMM Files\NURP.cpz

31 - Sidewalks 1: 0.007 ac. Connected PSD File: C:\WinSLAMM Files\NURP.cpz

71 - Other Pervious Areas 1: 0.092 ac. Normal Sandy PSD File: C:\WinSLAMM Files\NURP.cpz

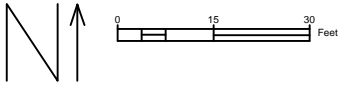

OWNER
 PEG ENTERPRISES LLC
 2930 AIRPORT ROAD
 LA CROSSE, WI 54601

CONTRACTOR
 WESER BROTHERS GENERAL CONTRACTOR, INC
 200 TWILITE STREET
 LA CRESCENT, MN 55947
 507.895.8903

DESIGNER
 MAKEPEACE ENGINEERING LLC
 200 MASON STREET #15
 ONALASKA, WI 54650
 608.881.6030

LEGAL DESCRIPTION
 AIRPORT INDUSTRIAL PARK LOT 20
 LOT SIZE: 63656 SF

PROJECT ADDRESS
 2930 AIRPORT ROAD
 CITY OF LA CROSSE
 LA CROSSE COUNTY, WI

BENCHMARK
 TBD

CURRENT ZONING: M2—HEAVY INDUSTRIAL
PROPOSED USE: GYMNASIUM
DISTURBED AREA: 29,707 SF
PROPOSED ADDITION AREA: 6,871 SF

ADJACENT	LAND USES
SOUTH	INDUSTRIAL
WEST	AIRPORT ROAD R-0-W
NORTH	INDUSTRIAL
EAST	AIRPORT

SIDE	SETBACK REQUIRED
FRONT	NONE
REAR	9'
NORTH	NONE
SOUTH	NONE

CONDITION	IMPERVIOUS	PERVIOUS	TOTAL
EXISTING	1.00 ACRE	0.46 ACRE	1.46 ACRE
PROPOSED	1.18 ACRE	0.28 ACRE	1.46 ACRE

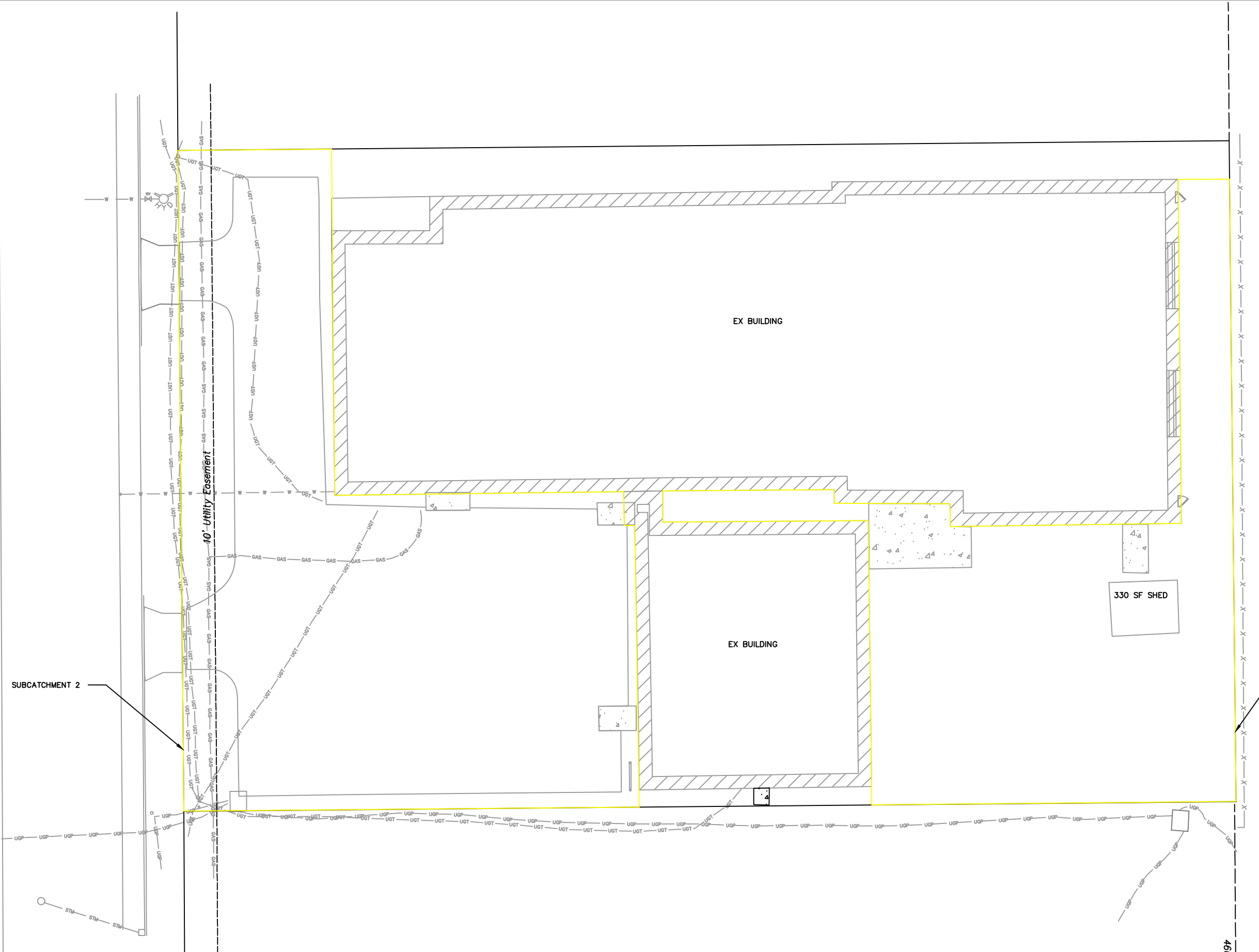

200 MASON STREET #15
 ONALASKA, WI 54650
 608.881.6030

PERFORMANCE ELITE GYMNASIICS
 2023 ADDITION
 CITY OF LA CROSSE
 LA CROSSE COUNTY

05/22/2023



SUBCATCHMENTS
 EX SITE

DATE	REVISION	DESCR.