

Cold Springs Condominium

Parts of Lots 12 - 22, part vacated alley, Block 2 and part of Lot 20, part of vacated alley, Block 3 and part of vacated Spring Street, all in Cold Springs Addition, located in the SE ¼ of the NE ¼, Section 21, T16N-R7W City of La Crosse, La Crosse County, Wisconsin

Graphic Scale

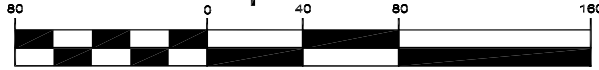

(in feet)
1 inch = 80 ft.

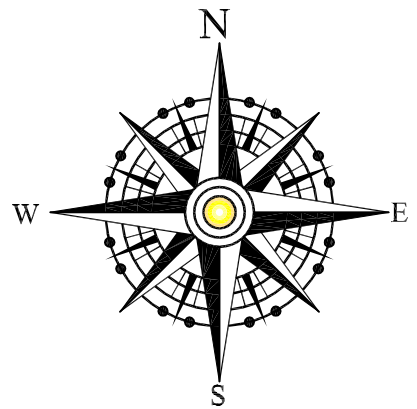
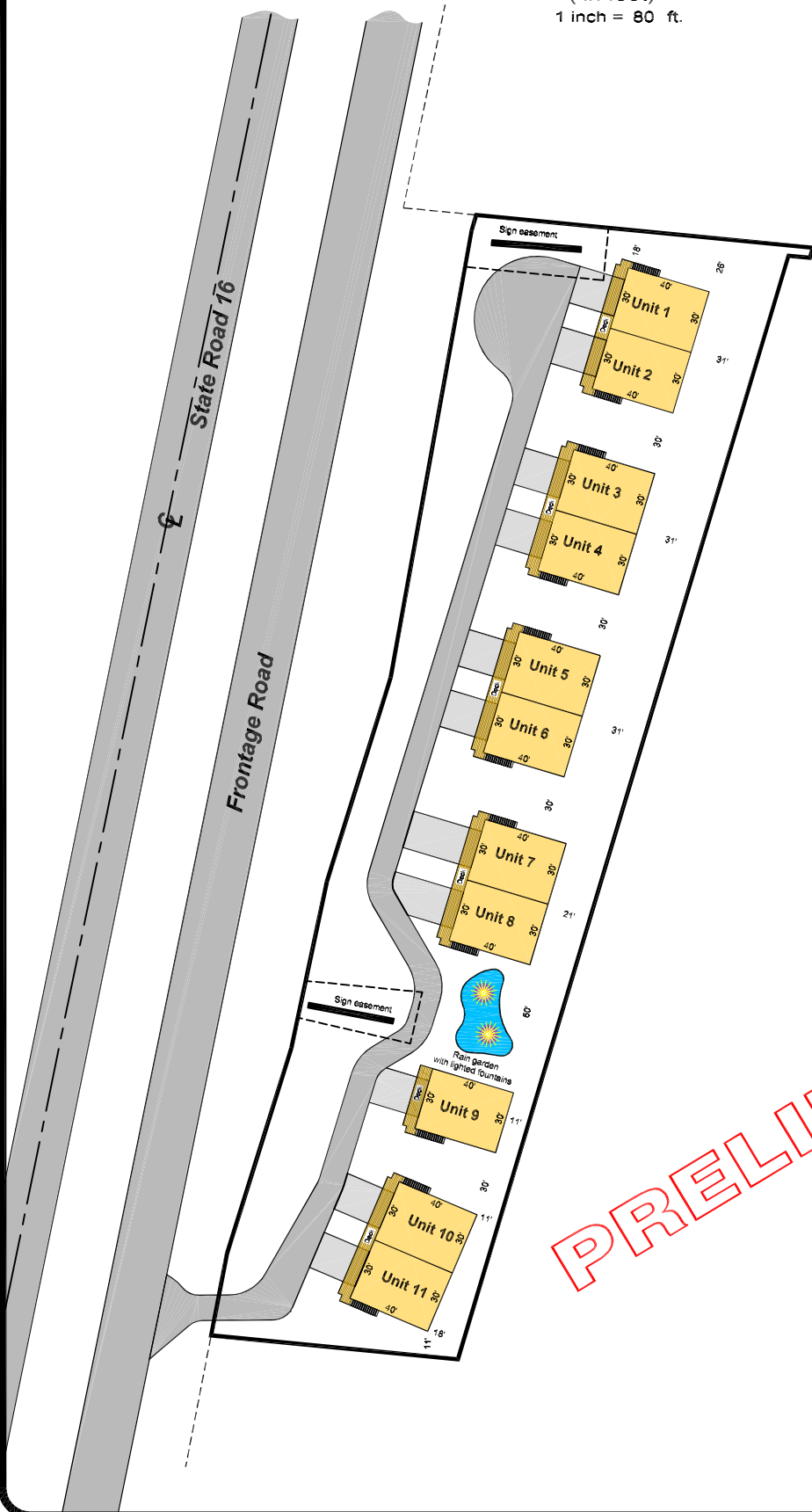

PRELIMINARY