

## Beautify La Crosse Volunteer Planting Application

**Name or Organization:** Lindsay Steiner      **Date:** 4/25/2024

**Address:** 717 24<sup>th</sup> St. N.      **City:** La Crosse      **State:** WI      **Zip:** 54601

**Telephone:** (608) 518-8747      **E-mail:** lbpsteiner@gmail.com

**Location type:** Boulevard

**Location Address or Parcel Number:** 717 24<sup>th</sup> St. N., La Crosse, WI, 54601

**What is your intention for this area?** New planting

**Please explain:** I would like to replace the grass with native plants on the boulevard on my property. This is a very sunny and dry location, and the grass has not done well. A selection of full sun/dry soil-loving native plants will thrive in this location.

**Project plan and materials:** *See page 2 for a sample design.*

**Materials:** Materials used may include supplementary soil/compost, mulch, and low-profile edging to separate the end of my boulevard area from my neighbor's boulevard.

**Plant List:** All plants used will be native and no taller than 30 inches. A goal is to include plants that support pollinators from early spring to late fall. Possibilities include: Butterfly Weed (*Asclepias tuberosa*), Prairie Dropseed (*Sporobolus heterolepis*), Hairy Beardtongue (*Penstemon hirsutus*), Cream Wild Indigo (*Baptisia bracteata*), Nodding Onion (*Allium cernuum*), Cliff Goldenrod (*Solidago sciaphila*), Old Field Goldenrod (*Solidago nemoralis*), Pasque Flower (*Anemone patens* var. *wolfgangiana*), and/or native species of similar height and sun/soil requirements. I will also try to choose plants that are salt-tolerant.

**Maintenance Plan:** I am an experienced gardener and enjoy building and maintaining my home gardens. I will plant low-maintenance native plants in this location. I will provide supplementary water as needed, and will maintain the garden appropriately for the safety and accessibility of pedestrians/motorists and the support of the environment/pollinators. Once approved but before preparing the area and planting, I will call the Digger's Hotline to locate buried utility lines.

---

### For Office Use Only:

**Approved by:** \_\_\_\_\_

\_\_\_\_\_ (print) \_\_\_\_\_ (sign)

**Date:** \_\_\_\_\_

Sample boulevard garden design  
Steiner, 717 24th St. N., La Crosse

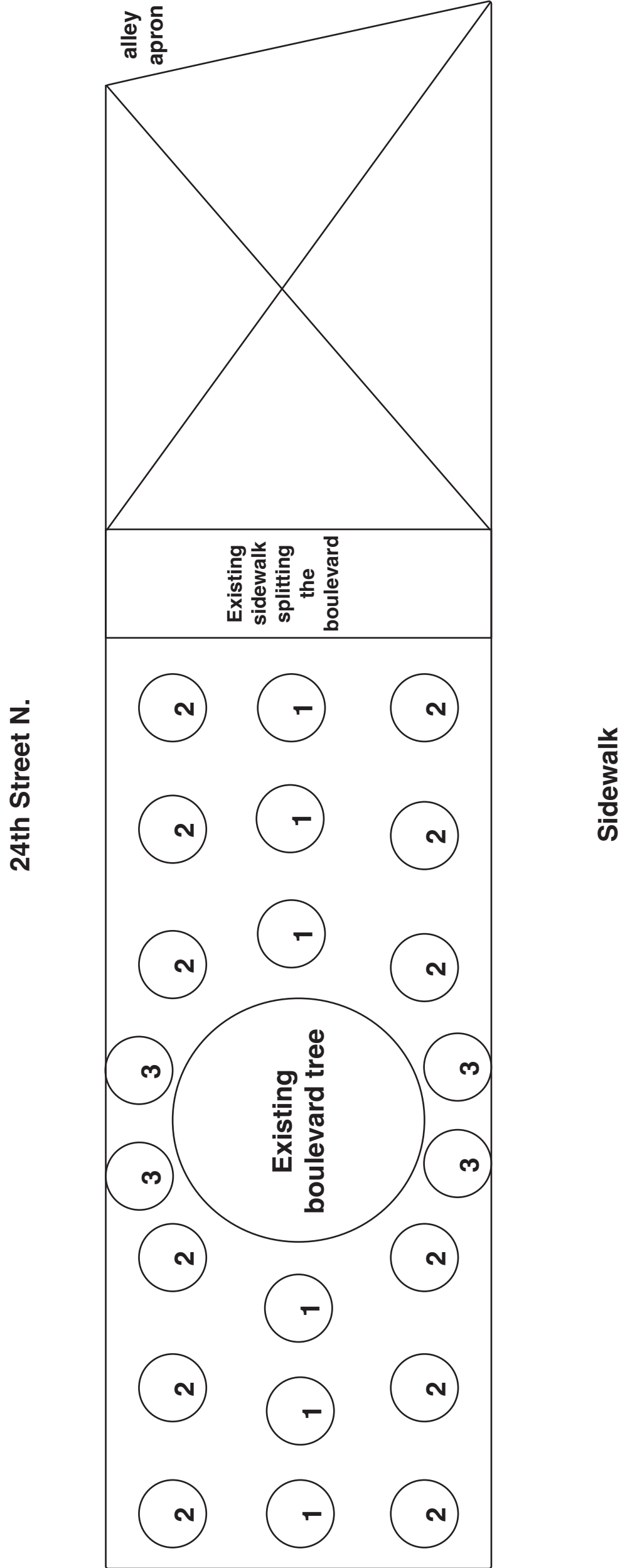

Sidewalk

**Plant key:** (1) Butterfly Weed      (2) Prairie Dropseed      (3) Hairy Beardtongue  
\*Other plants listed in the application may be installed depending on availability and design choices. This is a sample design that represents the intent of the project.