

### LANDSCAPE REQUIREMENTS

#### AS REQUIRED IN LA CROSSE, WI ZONING CODE (ZONE PD)

LOCATION	TYPE	REQUIRED	PROVIDED
YARDS / SETBACKS	OVERALL SITE LANDSCAPING REQUIREMENTS	ONE (1) SHADE TREE PER FORTY (40) LINEAR FEET OF LOT FRONTAGE.	300 LF OF LOT FRONTAGE; 300 LF / 40 = 8 REQUIRED TREES. A TOTAL OF 8 SHADE TREES IS PROVIDED ON SITE TO MEET THIS REQUIREMENT.
YARDS / SETBACKS	BOULEVARD LANDSCAPING REQUIREMENTS	ONE (1) SHADE TREE PLACED IN THE BOULEVARD PER FORTY (40) LINEAR FEET OF LOT FRONTAGE.	300 LF OF LOT FRONTAGE; 300 LF / 40 = 8 REQUIRED TREES. DUE TO THE WIDTH OF EXISTING BOULEVARD, NO TREES PLACED IN THE BOULEVARD IS PROVIDED.
OVERALL SITE	OVERALL SITE LANDSCAPING REQUIREMENTS	ONE (1) TREE AND TEN (10) SHRUBS PER SIX-HUNDRED (600) SQUARE FEET OF LANDSCAPED AREA.	80,176 SF OF LANDSCAPED AREA; 80,176 SF / 600 = 133 REQUIRED TREES; (80,176 SF/600) X 10 = 1,330 REQUIRED SHRUBS; PROVIDED ON PLAN IS 55 TREES AND 816 SHRUBS.
PARKING LOT	PARKING LOT SCREENING	WHERE VISIBLE FROM THE STREET AND WITHIN FIFTY (50) FEET OF THE RIGHT OF WAY, PARKING AREAS SHALL BE SCREENED BY A CONTINUOUS ROW OF SHRUBS OR NATURAL LANDSCAPE SCREENING TECHNIQUE THAT WILL REACH MAX. HT. OF THREE (3) FEET WITHIN TWO (2) YEARS.	A CONTINUOUS ROW OF SHRUBS WITH A MAX. OF 3' HT. IS PROVIDED WHERE PARKING LOT IS VISIBLE WITHIN 50' OF R.O.W.
PARKING LOT	PARKING LOT SCREENING	PROVIDE A FIVE-TO-SIX-HIGH SOLID SCREEN TO SEPARATE PARKING LOTS FROM ABUTTING RESIDENTIAL USES OR OTHER NON-COMPATIBLE USES. A SOLID LANDSCAPE SCREEN IS DEFINED AS AN EVERGREEN OR NEARLY EVERGREEN MIXTURE (65% EVERGREEN) OF SHRUBS OR TREES.	A LANDSCAPE BED WITH A VARIETY OF 36" DIA. SHRUBS AND A COMBINATION OF EVERGREEN AND SHADE TREES ALONG THE EAST PERIMETER OF THE PARKING LOT TO PROVIDE SUFFICIENT SCREENING FROM ADJACENT PROPERTY.
OVERALL SITE	COMMUNITY SPACE	EACH MULTI-FAMILY SITE SHALL INCLUDE A MIN. OF TWO-HUNDRED (200) SF OF OUTDOOR RECREATIONAL SPACE AT GROUND LEVEL SUITABLE FOR OUTDOOR RECREATION. FOR MULTI-FAMILY SITES WITH MORE THAN TWO (2) UNITS, THE OUTDOOR SPACE SHALL INCREASE BY TWENTY-FIVE (25) SF PER ADDITIONAL BEDROOM.	50 UNITS WITH A TOTAL OF 82 BEDROOMS; 2,200 SF OF RECREATIONAL SPACE REQUIRED. A COMBINATION OF OPEN GREEN SPACE AND COMMUNITY PATIO SPACE PROVIDES +/- 6,000 SF OF RECREATIONAL SPACE.

PLANT SCHEDULE						
TREES	CODE	QTY	BOTANICAL / COMMON NAME	SIZE	ROOT	
	EV	14	EVERGREEN TREE	5' HT. MIN.	B & B	
	OR	18	ORNAMENTAL TREE	2.5' CAL	B & B	
	SH	23	SHADE TREE	3" CAL	B & B	
SHRUB AREAS		CODE	QTY	BOTANICAL / COMMON NAME	ROOT	SIZE
	SH1	667		SHRUB AREA TYPE 1 36" DIA. SHRUB O.C.	5 GAL.	CONT
	SH2	112		SHRUB AREA TYPE 2 48" DIA. SHRUB O.C.	5 GAL.	CONT
	SH6	37		SHRUB AREA TYPE 3 60" DIA. SHRUB O.C.	5 GAL.	CONT
PERENNIALS		CODE	QTY	BOTANICAL / COMMON NAME	ROOT	SIZE
	PE1	526		PERENNIAL AREA TYPE 1 24" DIA. PERENNIAL O.C.	3 GAL.	CONT

**NOTE:**  
THE CLARITY OF THESE PLANS DEPEND UPON COLOR COPIES. IF THIS TEXT DOES NOT APPEAR IN COLOR, THIS IS NOT AN ORIGINAL PLAN SET AND MAY RESULT IN MISINTERPRETATION.

THIS DOCUMENT IS THE PROPERTY OF I & S GROUP, INC. AND MAY NOT BE USED, COPIED OR DUPLICATED WITHOUT PRIOR WRITTEN CONSENT.

PROJECT

### 2301 7TH STREET HOUSING

LA CROSSE WISCONSIN

REVISION SCHEDULE		
DATE	DESCRIPTION	BY

PROJECT NO.	23-30104
FILE NAME	30104-C5-LAND
DRAWN BY	---
DESIGNED BY	---
REVIEWED BY	---
ORIGINAL ISSUE DATE	--/--
CLIENT PROJECT NO.	-

TITLE

### PLANTING PLAN

SHEET

C5-20

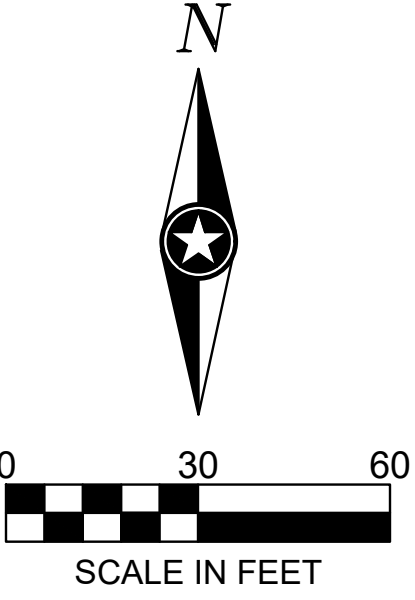



**PLANTING NOTES**

- COORDINATE LOCATION OF ALL UTILITIES (LINES, DUCTS, CONDUITS, SLEEVES, FOOTINGS, ETC.) WITH LOCATIONS OF PROPOSED LANDSCAPE ELEMENTS (FENCE, FOOTINGS, TREE ROOTBALLS, ETC.). CONTRACTOR SHALL REPORT ANY DISCREPANCIES TO OWNER'S REPRESENTATIVE PRIOR TO CONTINUING WORK.
- SAVE AND PROTECT ALL EXISTING TREES NOT NOTED TO BE REMOVED.
- REMOVE ALL CONSTRUCTION DEBRIS AND MATERIALS INJURIOUS TO PLANT GROWTH FROM PLANTING PITS AND BEDS PRIOR TO BACKFILLING WITH PLANTING MIX.
- REFER TO PLANTING DETAILS FOR AMENDED SOIL DEPTH IN PLANTING BEDS AND SURROUNDING TREES.
- FIELD STAKE PLANTINGS ACCORDING TO PLAN. OWNER'S REPRESENTATIVE SHALL APPROVE ALL PLANT LOCATIONS PRIOR TO INSTALLATION. OWNER'S REPRESENTATIVE RESERVES THE RIGHT TO REVISE PLANTING LAYOUT AT TIME OF INSTALLATION.
- ALL PLANT MATERIALS SHALL BE TRUE TO THEIR SCIENTIFIC NAME AND SIZE AS INDICATED IN THE PLANT SCHEDULE.
- IF DISCREPANCIES EXIST BETWEEN THE NUMBER OF PLANTS DRAWN ON THE PLANTING PLAN AND THE NUMBER OF PLANTS IN THE SCHEDULE, THE PLANTING PLAN SHALL GOVERN.
- ANY PROPOSED SUBSTITUTIONS OF PLANT SPECIES SHALL BE MADE WITH PLANTS OF EQUIVALENT OVERALL FORM, HEIGHT, BRANCHING HABIT, FLOWER, LEAF, COLOR, FRUIT AND CULTURE, AND ONLY AFTER WRITTEN APPROVAL OF THE OWNER'S REPRESENTATIVE.
- ALL PLANT MATERIALS MUST CONFORM TO AMERICAN STANDARDS FOR NURSERY STOCK (ANSI Z60.1), LATEST EDITION PUBLISHED BY THE AMERICAN ASSOCIATION OF NURSERYMEN, WASHINGTON D.C. LARGER SIZED PLANT MATERIALS OF THE SPECIES LISTED MAY BE USED IF THE STOCK CONFORMS TO ANSI Z60.1.
- ALL PLANT MATERIAL SHALL BE GUARANTEED BY THE CONTRACTOR TO BE IN A LIVE AND HEALTHY GROWING CONDITION FOR ONE FULL GROWING SEASON (ONE YEAR) AFTER FINAL PROJECT ACCEPTANCE OR SHALL BE REPLACED BY THE CONTRACTOR FREE OF CHARGE WITH THE SAME GRADE AND SPECIES.
- ALL TREES SHALL HAVE A STRONG CENTRAL LEADER. ANY TREES DEEMED NOT TO HAVE A STRONG CENTRAL LEADER SHALL BE REJECTED.
- CONTRACTOR IS RESPONSIBLE FOR ALL DAMAGE DUE TO CONSTRUCTION OPERATIONS. ANY AREAS THAT ARE DISTURBED SHALL BE RESTORED TO ITS ORIGINAL CONDITION AT NO ADDITIONAL COST TO THE OWNER.
- PROVIDE SHREDDED HARDWOOD MULCH SURROUNDING ALL PROPOSED TREES (5' Ø) AND WITHIN PLANTING BEDS TO A 3" MINIMUM DEPTH AS SHOWN IN TREE PLANTING DETAIL. DO NOT USE AN UNDERLAYMENT SUCH AS PLASTIC SHEET OR LANDSCAPE FABRIC. APPLY PRE-EMERGENT TO ALL PLANTING BEDS PRIOR TO MULCHING. REFER TO PLANS FOR ADDITIONAL DETAILS. REFER TO STORMWATER DETAILS FOR BASIN CONSTRUCTION AND MULCH APPLICATION.
- MULCHING MATERIAL SHALL BE SHREDDED HARDWOOD MULCH, WITH NO INDIVIDUAL PIECES LARGER THAN 3". FREE OF GROWTH OR GERMINATION INHIBITING INGREDIENTS. 3" MINIMUM DEPTH. MINIMUM DEPTHS AT LOCATIONS INDICATED ON DRAWINGS.
- CONTRACTOR SHALL PROVIDE SAMPLE OF MULCH TO BE APPROVED BY THE LANDSCAPE ARCHITECT.
- INDICATED QUANTITIES ARE ESTIMATES AND SHALL BE CONFIRMED BY THE CONTRACTOR.
- ADJUST SPACING OF PLANT MATERIALS AROUND ADJACENT UTILITY STRUCTURES.

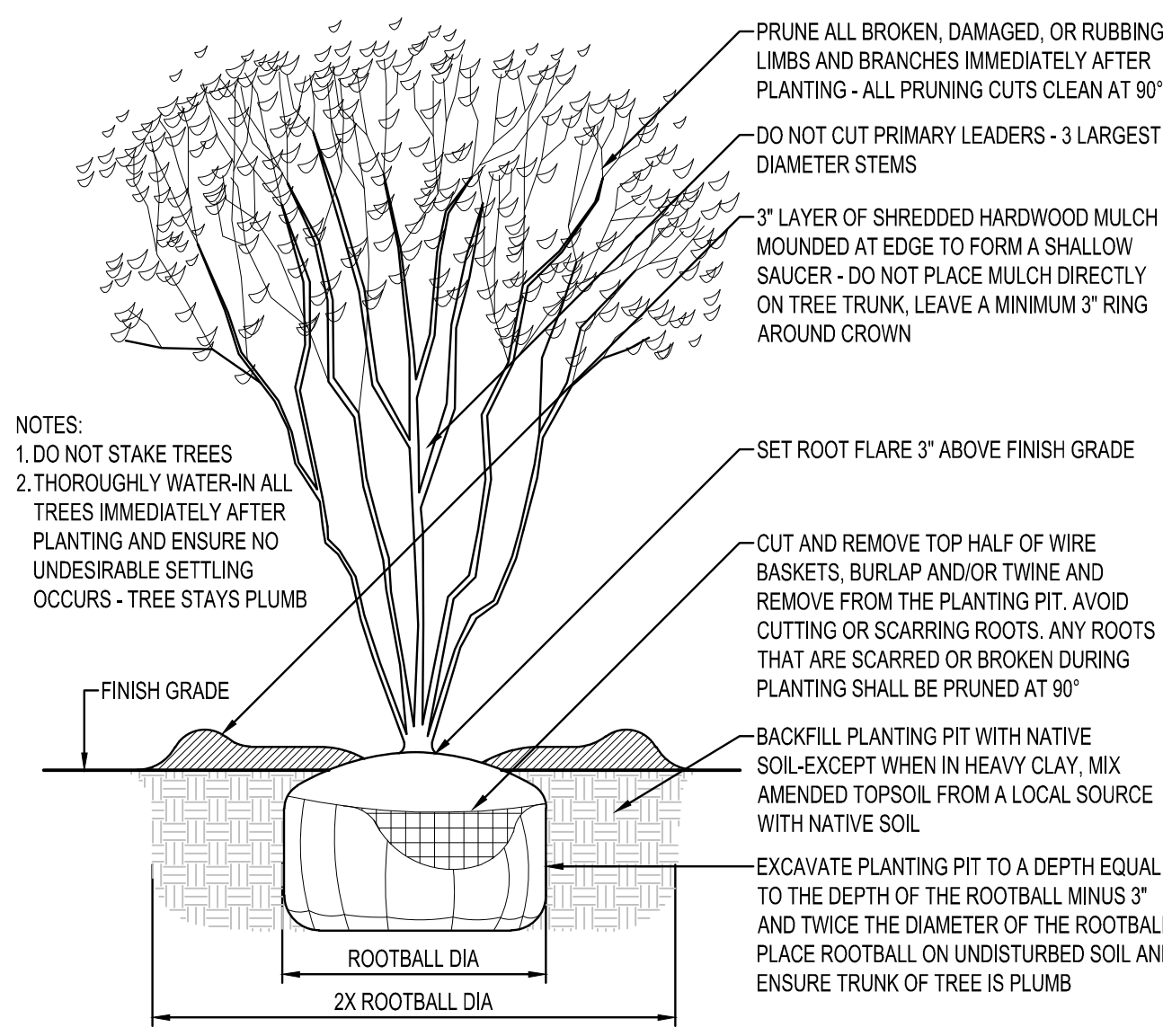

NOTES:  
1. DO NOT STAKE TREES  
2. THOROUGHLY WATER IN ALL TREES IMMEDIATELY AFTER PLANTING AND ENSURE NO UNDESIRABLE SETTLING OCCURS - TREE STAYS PLUMB

**MULTI-STEM TREE PLANTING**

NTS

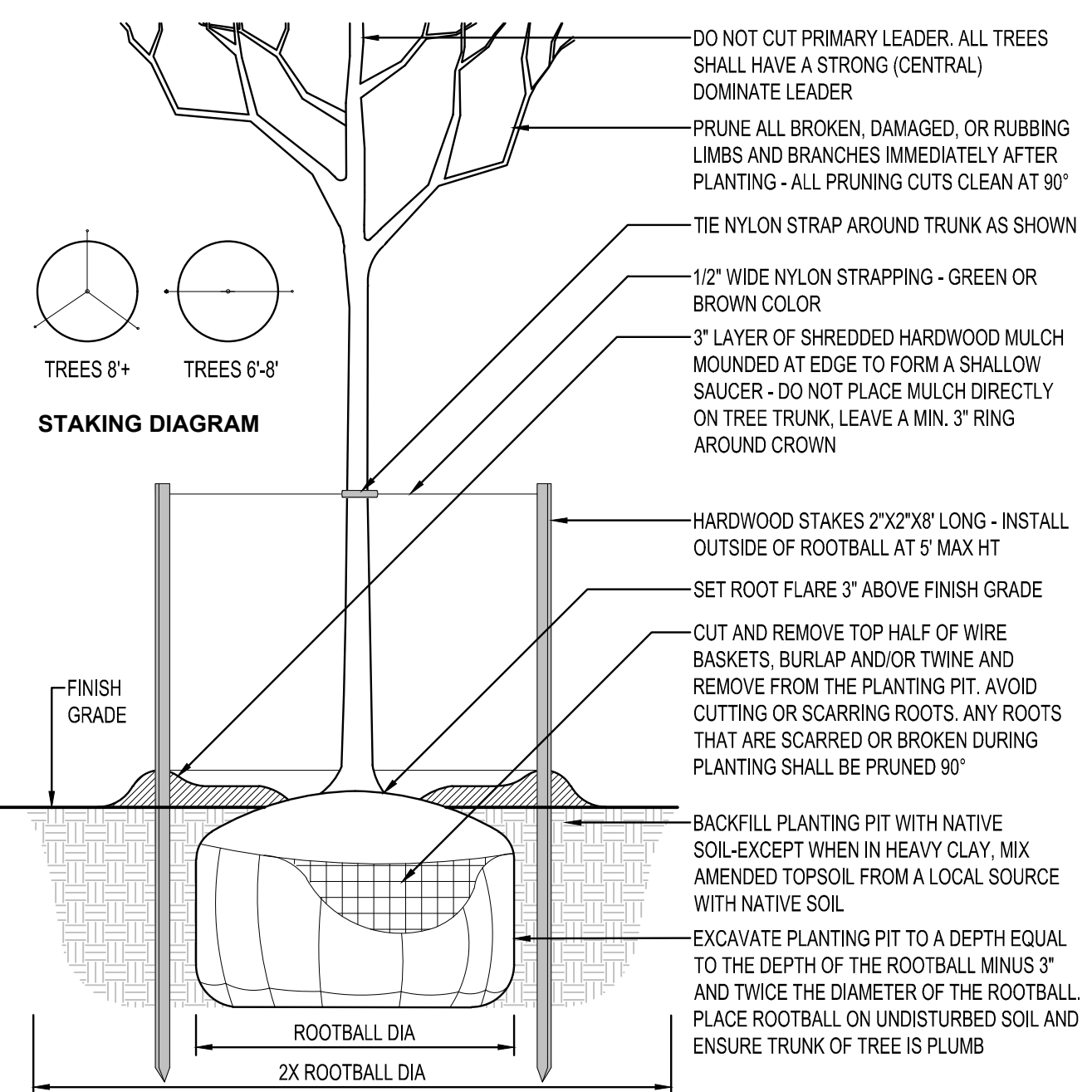

**STAKING DIAGRAM**

**DECIDUOUS TREE PLANTING**

NTS

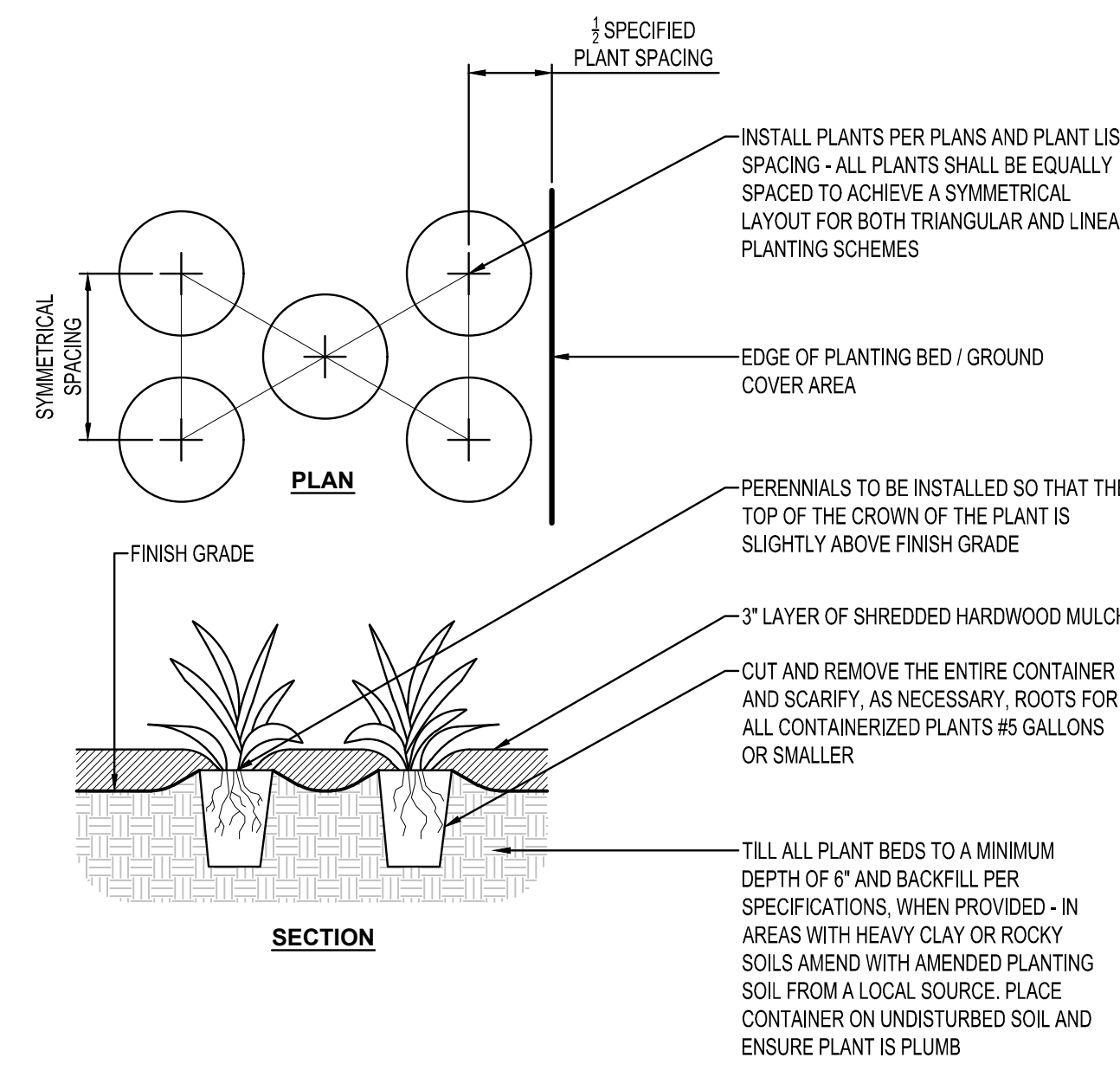

**PERENNIAL PLANTING**

NTS

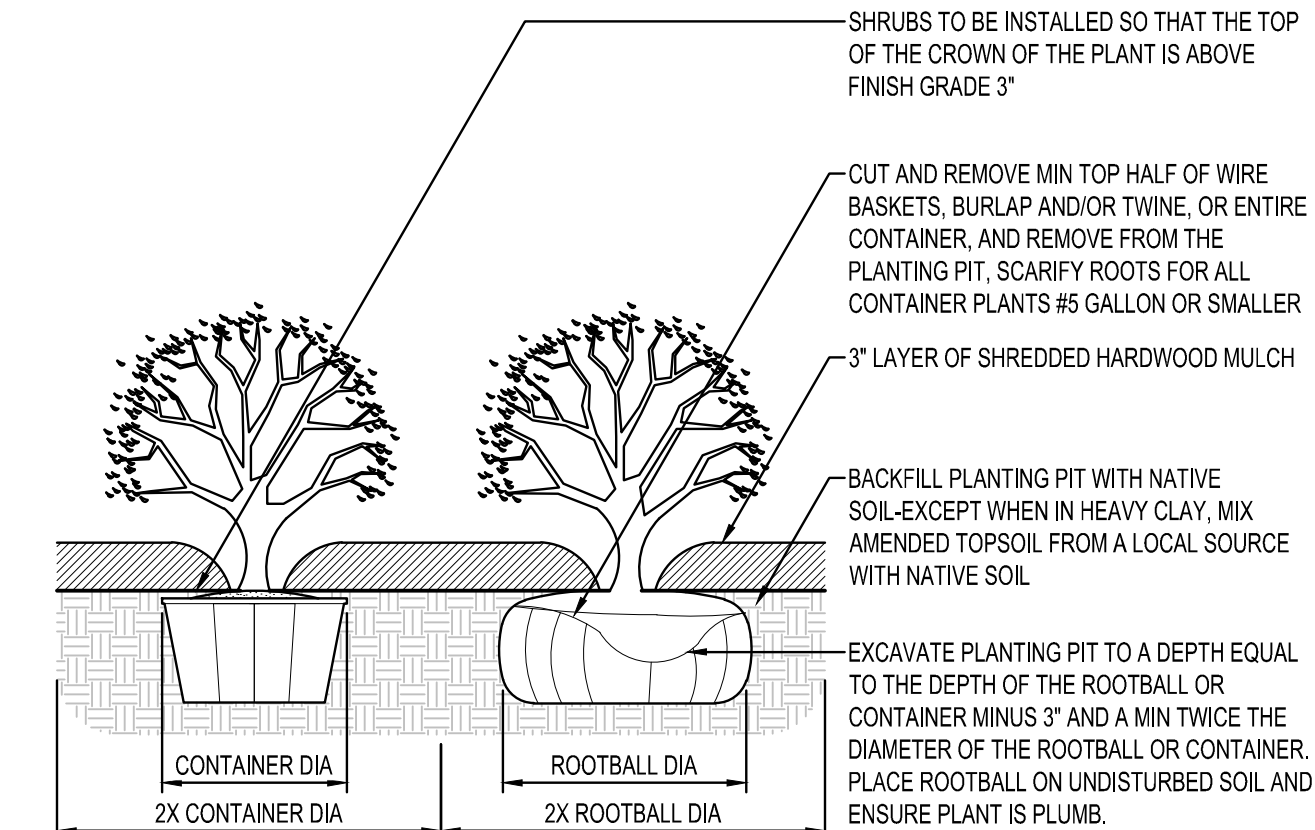

**SHRUB PLANTING**

NTS

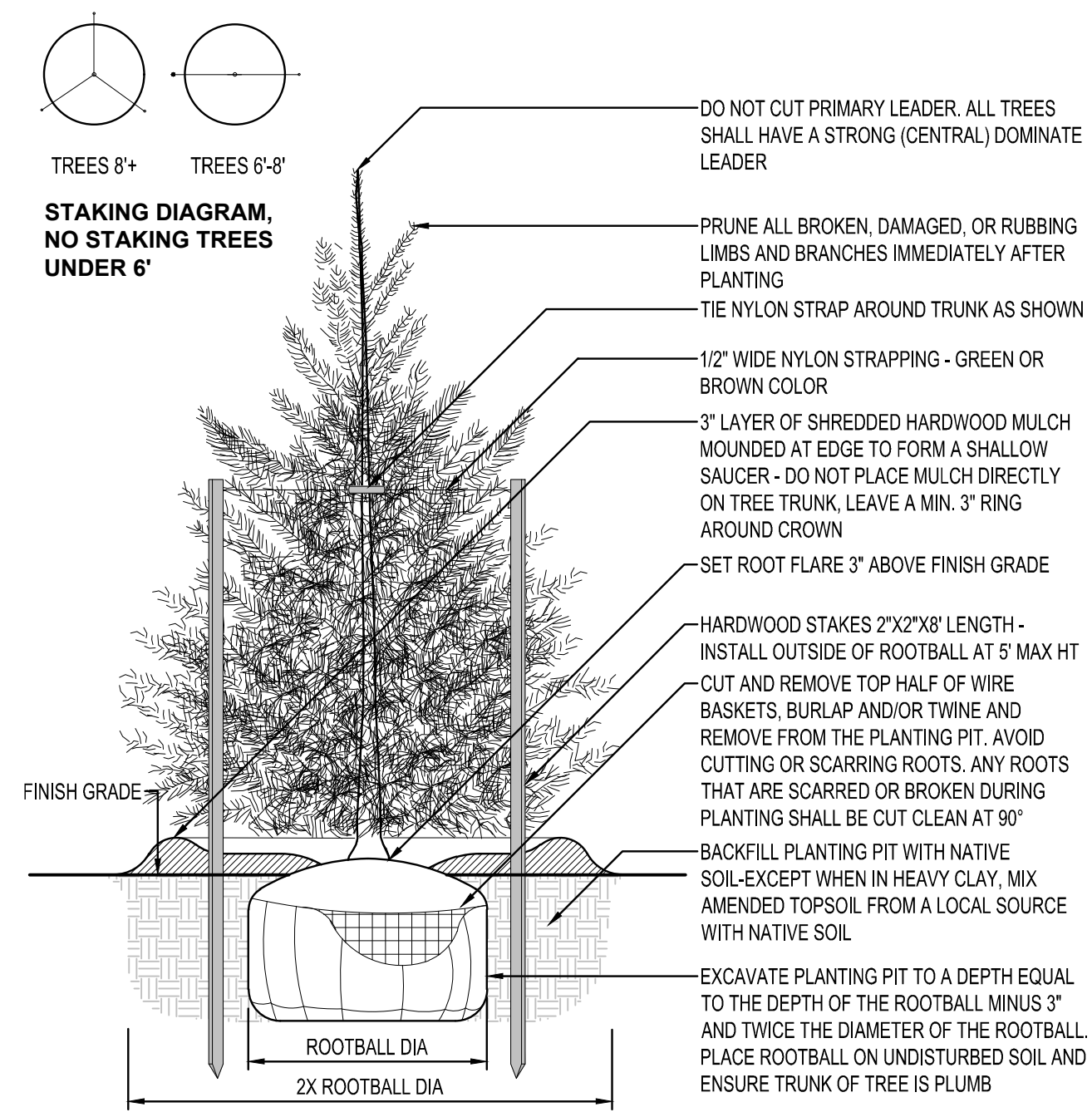

**STAKING DIAGRAM, NO STAKING TREES UNDER 6'**

**EVERGREEN TREE PLANTING**

NTS

**NOTE:**  
THE CLARITY OF THESE PLANS DEPEND UPON COLOR COPIES. IF THIS TEXT DOES NOT APPEAR IN COLOR, THIS IS NOT AN ORIGINAL PLAN SET AND MAY RESULT IN MISINTERPRETATION.

THIS DOCUMENT IS THE PROPERTY OF I & S GROUP, INC. AND MAY NOT BE USED, COPIED OR DUPLICATED WITHOUT PRIOR WRITTEN CONSENT.

PROJECT

**2301 7TH STREET HOUSING**

LA CROSSE WISCONSIN

REVISION SCHEDULE		
DATE	DESCRIPTION	BY

PROJECT NO.	23-30104
FILE NAME	30104-C5-LAND
DRAWN BY	---
DESIGNED BY	---
REVIEWED BY	---
ORIGINAL ISSUE DATE	---/---/---
CLIENT PROJECT NO.	---

TITLE

**PLANTING NOTES AND DETAILS**

SHEET

**C5-30**